

## **Annex 3b**

### **Public Rights of Way – Wildlife & Countryside Act 1981, Preparation of Definitive Map for Former County Borough**

#### **Westfield Ward**

#### **Index**

Location Plan

Schedules & Path Plans

Path Nos    91-94  
                  96-116

#### **Summary of Recommendations**

DMMO Recommended Path Nos

91, 92, 93, 94, 98, 99, 100, 101, 102, 103, 104, 105, 106, 107, 108, 109, 110,  
111, 112, 113, 114, 116

No Further Action Recommended Path Nos

96, 97, 115

**Public Rights Of Way – Wildlife & Countryside Act 1981  
Preparation of Definitive Map Former County Borough of York – Westfield**

Schedule 26

**Ward:** Westfield  
**Status:** Public Footpath  
**Path No:** 88 (Westfield)

**Description of route**

Footpath running south between 96 & 98 Foxwood Lane to Corlett Court.

**Approximate length**

25 Metres

**Nature of Surface:**

<u>Start Grid Reference</u>	<u>End Grid Reference</u>	<u>Surface Type</u>
SE 5707 4998	SE 5707 4996	Tarmac

**Approximate Width:**

<u>Start Grid Reference</u>	<u>End Grid Reference</u>	<u>Width</u>
SE 5707 4998	SE 5707 4996	1.5m

**Structures: (Stiles, Gates and Bridges etc)**

<u>Structure</u>	<u>Grid Reference</u>	<u>Structure Reference</u>
------------------	-----------------------	----------------------------

**Evidence Summary etc**

Documentary Evidence etc	Yes	No	Date (if applicable)	Other Information
OS Plans	✓		1987	
Inclosure				
Tithe				
1910 Finance Act				
Rights of Way Act 1932				
Railway/Canal Plans				
Other Maps				
User Evidence				
Photographs	✓			Taken as part of CYC surveys

Utility Companies Affected	Yes	No	Date (if applicable)	Other Information
British Gas		✓		
BT		✓		
Cable & Wireless		✓		
Northern Electric		✓		
NTL Network Services		✓		
Torch Telecom		✓		
Yorkshire Water		✓		
York Waterworks		✓		

**Recommendation:**

Make Order to add route to Definitive Map and Statement

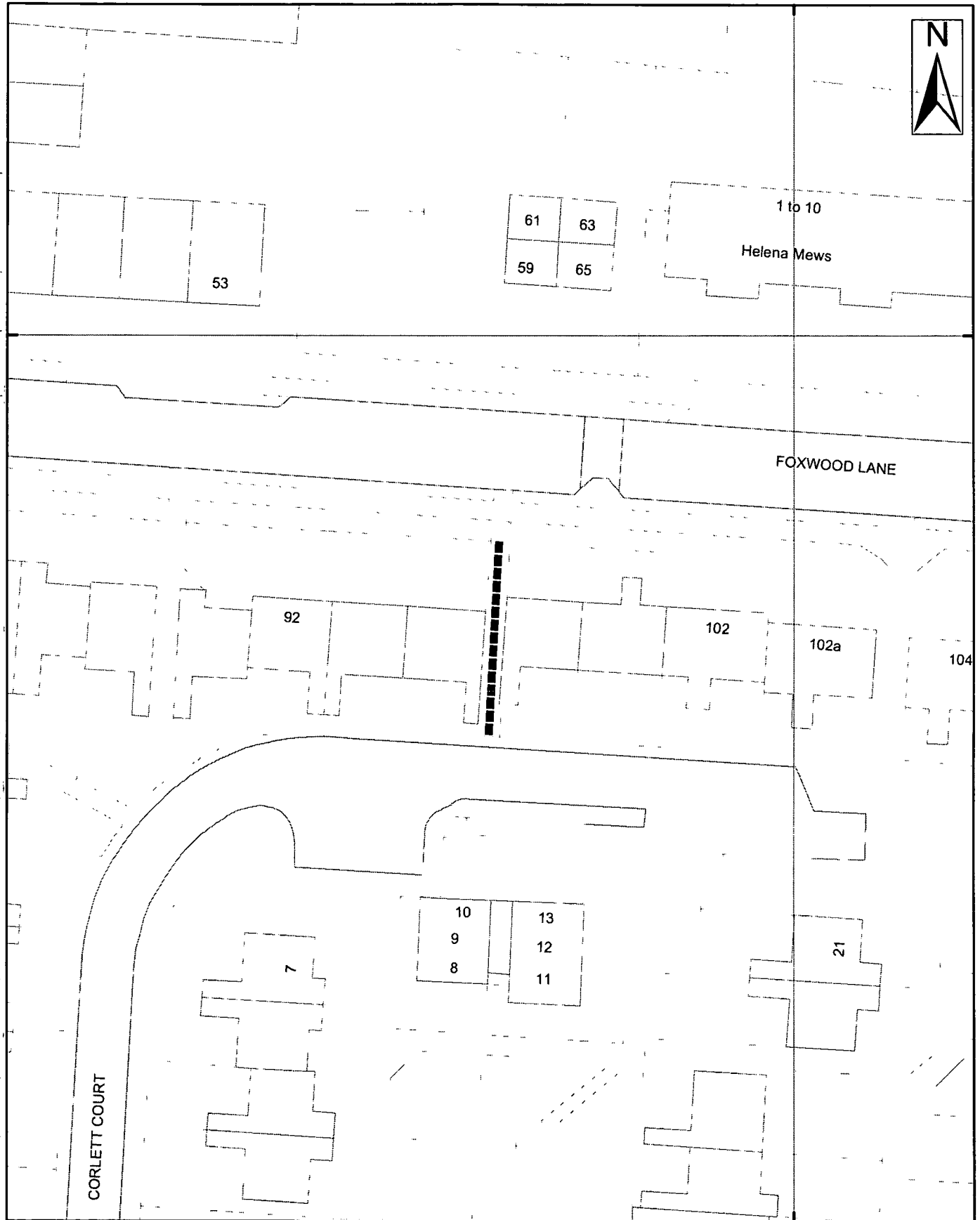

9 St. Leonards Place, York, YO1 2ET  
Telephone: 01904 613161

### York, Footpath No 88 (Westfield Ward)

Scale 1:500

Drawn By:

Date:

Public Rights of Way

Reference:

Drawing No.

Reproduced from the Ordnance Survey with the permission of the Controller of Her Majesty's Stationery Office © Crown copyright. Unauthorised reproduction infringes Crown copyright and may lead to prosecution or civil proceedings. City of York Council 100020R18

**Public Rights Of Way – Wildlife & Countryside Act 1981  
Preparation of Definitive Map Former County Borough of York – Westfield**

Schedule 27

**Ward:** Westfield  
**Status:** Public Footpath  
**Path No:** 91 (Westfield)

**Description of route**

Footpath running eastward along southern edge of Morrell Court playground at rear of 15-17.

**Approximate length**

25 Metres

**Nature of Surface:**

<u>Start Grid Reference</u>	<u>End Grid Reference</u>	<u>Surface Type</u>
SE 5695 4991	SE 5698 4991	Tarmac

**Approximate Width:**

<u>Start Grid Reference</u>	<u>End Grid Reference</u>	<u>Width</u>
SE 56954991	SE 5698 4991	1.5m

**Structures: (Stiles, Gates and Bridges etc)**

<u>Structure</u>	<u>Grid Reference</u>	<u>Structure Reference</u>
------------------	-----------------------	----------------------------

**Evidence Summary etc**

Documentary Evidence etc	Yes	No	Date (if applicable)	Other Information
OS Plans	✓		1987	
Inclosure				
Tithe				
1910 Finance Act				
Rights of Way Act 1932				
Railway/Canal Plans				
Other Maps				
User Evidence				
Photographs	✓			Taken as part of CYC surveys

Utility Companies Affected	Yes	No	Date (if applicable)	Other Information
British Gas		✓		
BT		✓		
Cable & Wireless		✓		
Northern Electric		✓		
NTL Network Services		✓		
Torch Telecom		✓		
Yorkshire Water		✓		
York Waterworks		✓		

**Recommendation:**

Make Order to add route to Definitive Map and Statement

457000 000000

FOXWOOD LANE



450000

70

80

82

8

11

to

9

14

to

12

MORRELL COURT

17

Playground

Hatfield Walk

14

1

15

17

9

449900

457000 000000



9 St. Leonards Place, York, YO1 2ET  
Telephone: 01904 613161

### York, Footpath No 91 (Westfield Ward)

Scale 1:500

Drawn By:

Date:

Public Rights of Way

Reference:

Drawing No.

Reproduced from the Ordnance Survey with the permission of the Controller of Her Majesty's Stationery Office © Crown copyright.  
Unauthorized reproduction infringes Crown copyright and may lead to prosecution or civil proceedings. City of York Council 100020818

**Public Rights Of Way – Wildlife & Countryside Act 1981  
Preparation of Definitive Map Former County Borough of York – Westfield**

Schedule 28

**Ward:** Westfield  
**Status:** Public Footpath  
**Path No:** 92 (Westfield)

**Description of route**

Footpath running south from rear of 8 Morrell Court to rear of 5 Walker Drive

**Approximate length**

65 Metres

**Nature of Surface**

<u>Start Grid Reference</u>	<u>End Grid Reference</u>	<u>Surface Type</u>
SE 5696 4995	SE 5695 4989	Tarmac

**Approximate Width:**

<u>Start Grid Reference</u>	<u>End Grid Reference</u>	<u>Width</u>
SE 5696 4995	SE 5695 4989	1.5m

**Structures: (Stiles, Gates and Bridges etc)**

<u>Structure</u>	<u>Grid Reference</u>	<u>Structure Reference</u>
------------------	-----------------------	----------------------------

**Evidence Summary etc**

Documentary Evidence etc	Yes	No	Date (if applicable)	Other Information
OS Plans	✓		1987	
Inclosure				
Tithe				
1910 Finance Act				
Rights of Way Act 1932				
Railway/Canal Plans				
Other Maps				
User Evidence				
Photographs	✓			Taken as part of CYC surveys

Utility Companies Affected	Yes	No	Date (if applicable)	Other Information
British Gas		✓		
BT		✓		
Cable & Wireless		✓		
Northern Electric		✓		
NTL Network Services		✓		
Torch Telecom		✓		
Yorkshire Water		✓		
York Waterworks		✓		

**Recommendation:**

Make Order to add route to Definitive Map and Statement

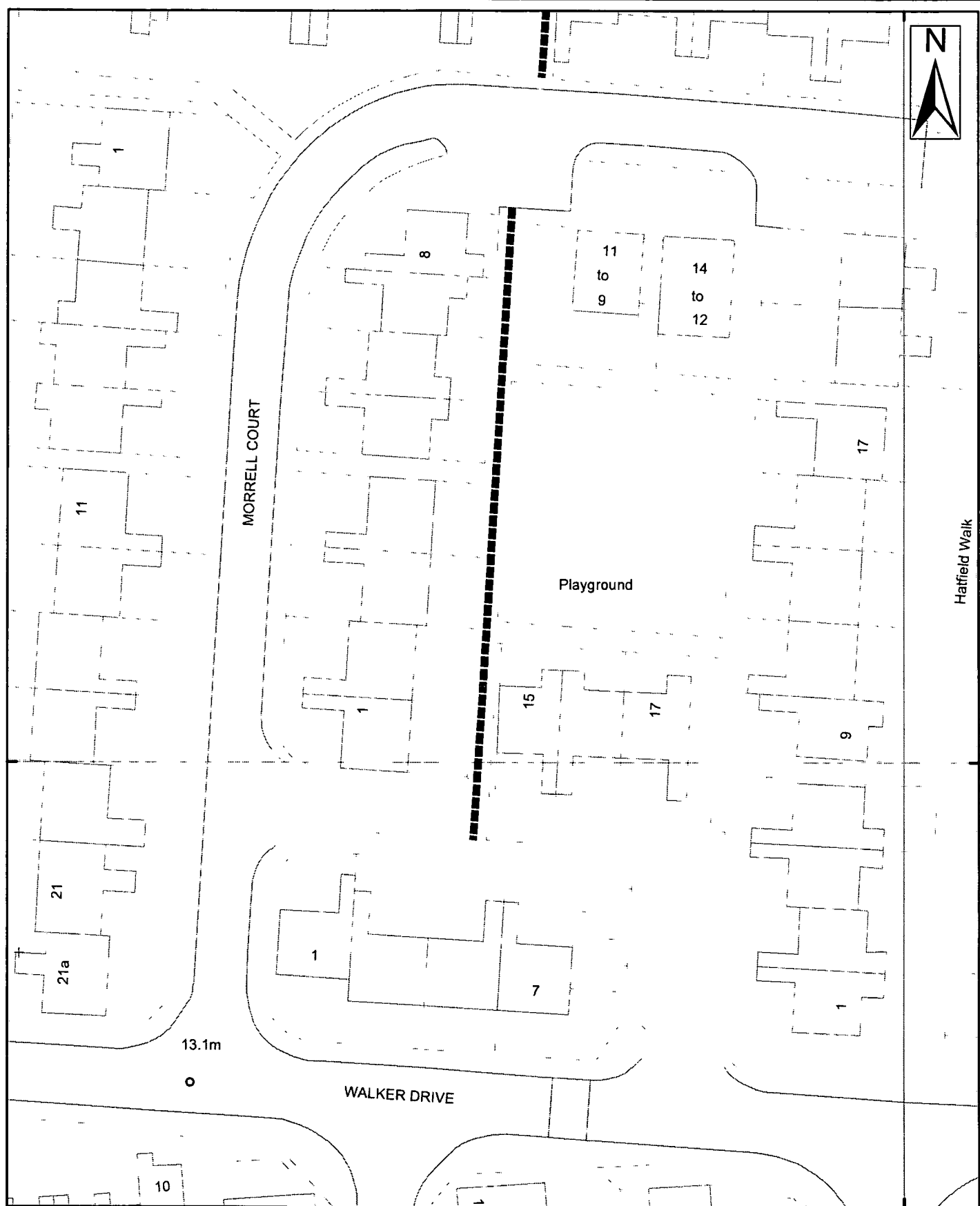

9 St. Leonards Place, York, YO1 2ET  
Telephone: 01904 613161

### York, Footpath No 92 (Westfield Ward)

Scale 1:523

Drawn By:

Date:

Public Rights of Way

Reference:

Drawing No.

Reproduced from the Ordnance Survey with the permission of the Controller of Her Majesty's Stationery Office © Crown copyright.  
Map data reproduced from Ordnance Survey with the permission of the Controller of Her Majesty's Stationery Office © Crown copyright.

**Public Rights Of Way – Wildlife & Countryside Act 1981  
Preparation of Definitive Map Former County Borough of York – Westfield**

Schedule 29

**Ward:** Westfield  
**Status:** Public Footpath  
**Path No:** 93 (Westfield)

**Description of route**

Footpath running south from Foxwood Lane between 70 & 72 to Morrell Court

**Approximate length**

20 Metres

**Nature of Surface:**

<u>Start Grid Reference</u>	<u>End Grid Reference</u>	<u>Surface Type</u>
SE 5696 4998	SE 5696 4996	Tarmac

**Approximate Width:**

<u>Start Grid Reference</u>	<u>End Grid Reference</u>	<u>Width</u>
SE 5696 4998	SE 5696 4996	1.5m

**Structures: (Stiles, Gates and Bridges etc)**

<u>Structure</u>	<u>Grid Reference</u>	<u>Structure Reference</u>
------------------	-----------------------	----------------------------

**Evidence Summary etc**

Documentary Evidence etc	Yes	No	Date (if applicable)	Other Information
OS Plans	✓		1987	
Inclosure				
Tithe				
1910 Finance Act				
Rights of Way Act 1932				
Railway/Canal Plans				
Other Maps				
User Evidence				
Photographs	✓			Taken as part of CYC surveys

Utility Companies Affected	Yes	No	Date (if applicable)	Other Information
British Gas		✓		
BT		✓		
Cable & Wireless		✓		
Northern Electric		✓		
NTL Network Services		✓		
Torch Telecom		✓		
Yorkshire Water		✓		
York Waterworks		✓		

**Recommendation:**

Make Order to add route to Definitive Map and Statement



457000



TCBs

450000

FOXWOOD LANE

60

70

80

1

8

11

to

9

14

to

12

17

MORRELL COURT

457000



### York, Footpath No 93 (Westfield Ward)

Scale 1:500

Drawn By:

Date:

Public Rights of Way

Reference:

Drawing No.

9 St. Leonards Place, York, YO1 2ET  
Telephone: 01904 613161

Reproduced from the Ordnance Survey with the permission of the Controller of Her Majesty's Stationery Office © Crown copyright.  
Unauthorized reproduction infringes Crown copyright and may lead to prosecution or civil proceedings. City of York Council 10000084

**Public Rights Of Way – Wildlife & Countryside Act 1981  
Preparation of Definitive Map Former County Borough of York – Westfield**

Schedule 30

**Ward:** Westfield  
**Status:** Public Footpath  
**Path No:** 94 (Westfield)

**Description of route**

Footpath running in an easterly direction from front of 1 Bellhouse Way to Morrell Court

**Approximate length**

30 Metres

**Nature of Surface:**

<u>Start Grid Reference</u>	<u>End Grid Reference</u>	<u>Surface Type</u>
SE 5691 4996	SE 5693 4996	Tarmac

**Approximate Width:**

<u>Start Grid Reference</u>	<u>End Grid Reference</u>	<u>Width</u>
SE 5691 4996	SE 5693 4996	1.3m

**Structures: (Stiles, Gates and Bridges etc)**

<u>Structure</u>	<u>Grid Reference</u>	<u>Structure Reference</u>
Cycle barrier	SE 5693 4996	Y094b

**Evidence Summary etc**

Documentary Evidence etc	Yes	No	Date (if applicable)	Other Information
OS Plans	✓		1987	
Inclosure				
Tithe				
1910 Finance Act				
Rights of Way Act 1932				
Railway/Canal Plans				
Other Maps				
User Evidence				
Photographs	✓			Taken as part of CYC surveys

Utility Companies Affected	Yes	No	Date (if applicable)	Other Information
British Gas		✓		
BT		✓		
Cable & Wireless		✓		
Northern Electric		✓		
NTL Network Services		✓		
Torch Telecom		✓		
Yorkshire Water		✓		
York Waterworks		✓		

**Recommendation:**

Make Order to add route to Definitive Map and Statement

456900



29

43

14.0m

FOXWOOD LANE

60

70

2

12

to  
9

13.5m

MORRELL COURT

11

8

Playground

456900



9 St. Leonards Place, York, YO1 2ET  
Telephone: 01904 613161

### York, Footpath No 94 (Westfield Ward)

Scale 1:500

Drawn By:

Date:

Public Rights of Way

Reference:

Drawing No.

Reproduced from the Ordnance Survey with the permission of the Controller of Her Majesty's Stationery Office © Crown copyright.  
Unauthorized reproduction infringes Crown copyright and may lead to prosecution or civil proceedings. City of York Council 100020818

450000

450000

450000

450000

450000

**Public Rights Of Way – Wildlife & Countryside Act 1981  
Preparation of Definitive Map Former County Borough of York – Westfield**

Schedule 31

**Ward:** Westfield  
**Status:** Public Footpath  
**Path No:** 96 (Westfield)

**Description of route**

Footpath running from side of 32 Bellhouse Way into Houndsway

**Approximate length**

25 Metres

**Nature of Surface:**

<u>Start Grid Reference</u>	<u>End Grid Reference</u>	<u>Surface Type</u>
SE 5688 4985	SE 5686 4985	Paved

**Approximate Width:**

<u>Start Grid Reference</u>	<u>End Grid Reference</u>	<u>Width</u>
SE 5688 4985	SE 5686 4985	1m

**Structures: (Stiles, Gates and Bridges etc)**

<u>Structure</u>	<u>Grid Reference</u>	<u>Structure Reference</u>

**Evidence Summary etc**

Documentary Evidence etc	Yes	No	Date (if applicable)	Other Information
OS Plans	✓		1987	
Inclosure				
Tithe				
1910 Finance Act				
Rights of Way Act 1932				
Railway/Canal Plans				
Other Maps				
User Evidence				
Photographs	✓			Taken as part of CYC surveys

Utility Companies Affected	Yes	No	Date (if applicable)	Other Information
British Gas		✓		
BT		✓		
Cable & Wireless		✓		
Northern Electric		✓		
NTL Network Services		✓		
Torch Telecom		✓		
Yorkshire Water		✓		
York Waterworks		✓		

**Recommendation:**

No further action at this time

456900

449900

449900

449900

449800

449900

449900

449800

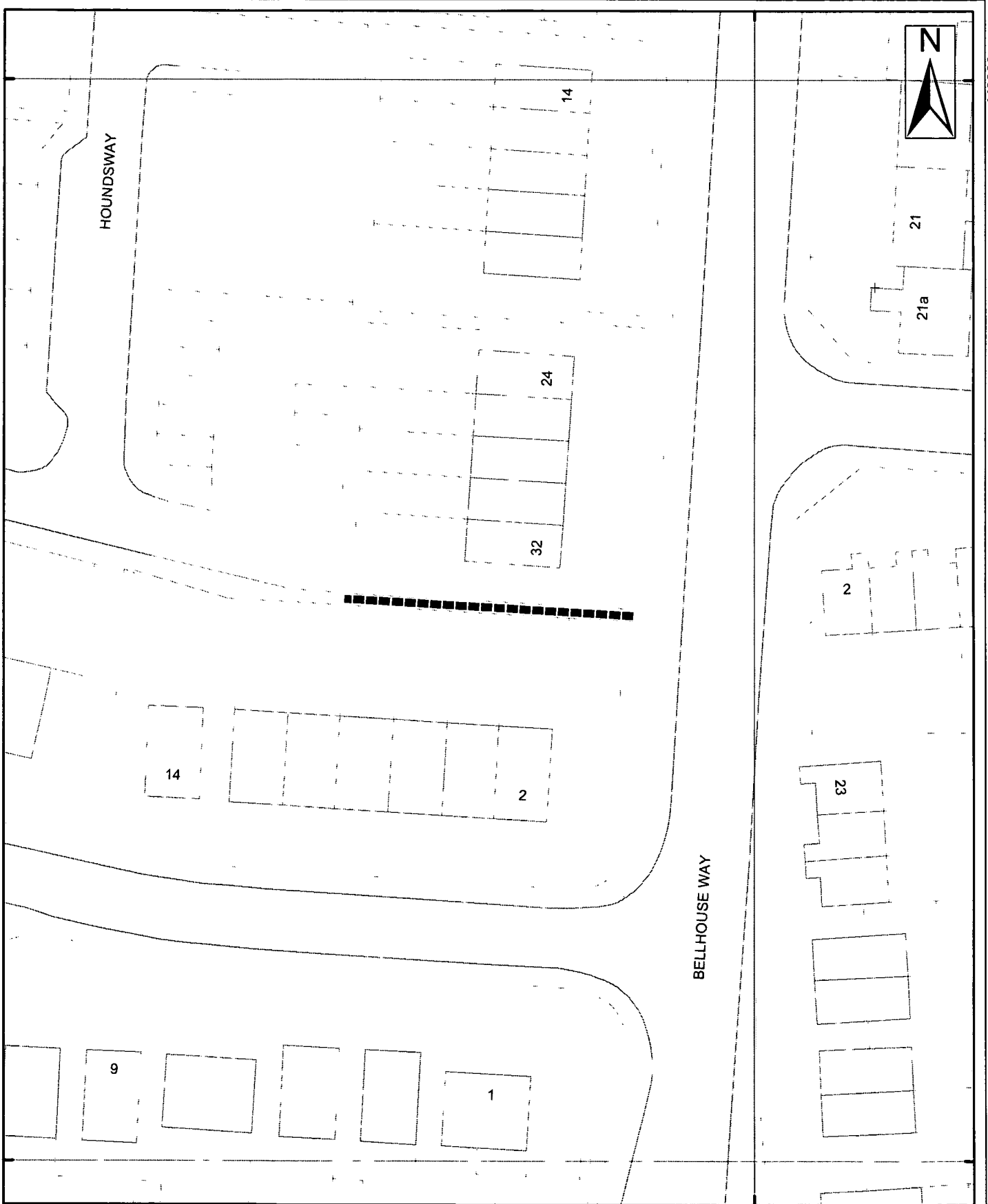

456900



9 St. Leonards Place, York, YO1 2ET  
 Telephone: 01904 613161

### York, Footpath No 96 (Westfield Ward)

Scale 1:481	Drawn By:	Date:
Public Rights of Way	Reference:	Drawing No.

Reproduced from the Ordnance Survey with the permission of the Controller of Her Majesty's Stationery Office © Crown copyright.  
 Unauthorised reproduction infringes Crown copyright and may lead to prosecution or civil proceedings. City of York Council 40000000

**Public Rights Of Way – Wildlife & Countryside Act 1981  
Preparation of Definitive Map Former County Borough of York – Westfield**

Schedule 32

**Ward:** Westfield  
**Status:** Public Footpath  
**Path No:** 97 (Westfield)

**Description of route**

Footpath running between 22 & 24 Bellhouse Way into Houndsway.

**Approximate length**

30 Metres

**Nature of Surface:**

<u>Start Grid Reference</u>	<u>End Grid Reference</u>	<u>Surface Type</u>
SE 5689 4987	SE 5686 4988	Paved

**Approximate Width:**

<u>Start Grid Reference</u>	<u>End Grid Reference</u>	<u>Width</u>
SE 5689 4987	SE 5686 4988	1m

**Structures: (Stiles, Gates and Bridges etc)**

<u>Structure</u>	<u>Grid Reference</u>	<u>Structure Reference</u>
------------------	-----------------------	----------------------------

**Evidence Summary etc**

Documentary Evidence etc	Yes	No	Date (if applicable)	Other Information
OS Plans	✓		1987	
Inclosure				
Tithe				
1910 Finance Act				
Rights of Way Act 1932				
Railway/Canal Plans				
Other Maps				
User Evidence				
Photographs	✓			Taken as part of CYC surveys

Utility Companies Affected	Yes	No	Date (if applicable)	Other Information
British Gas		✓		
BT		✓		
Cable & Wireless		✓		
Northern Electric		✓		
NTL Network Services		✓		
Torch Telecom		✓		
Yorkshire Water		✓		
York Waterworks		✓		

**Recommendation:**

No further action at this time

456900



449900 449900 449900 449900 449900 449900 449900 449900

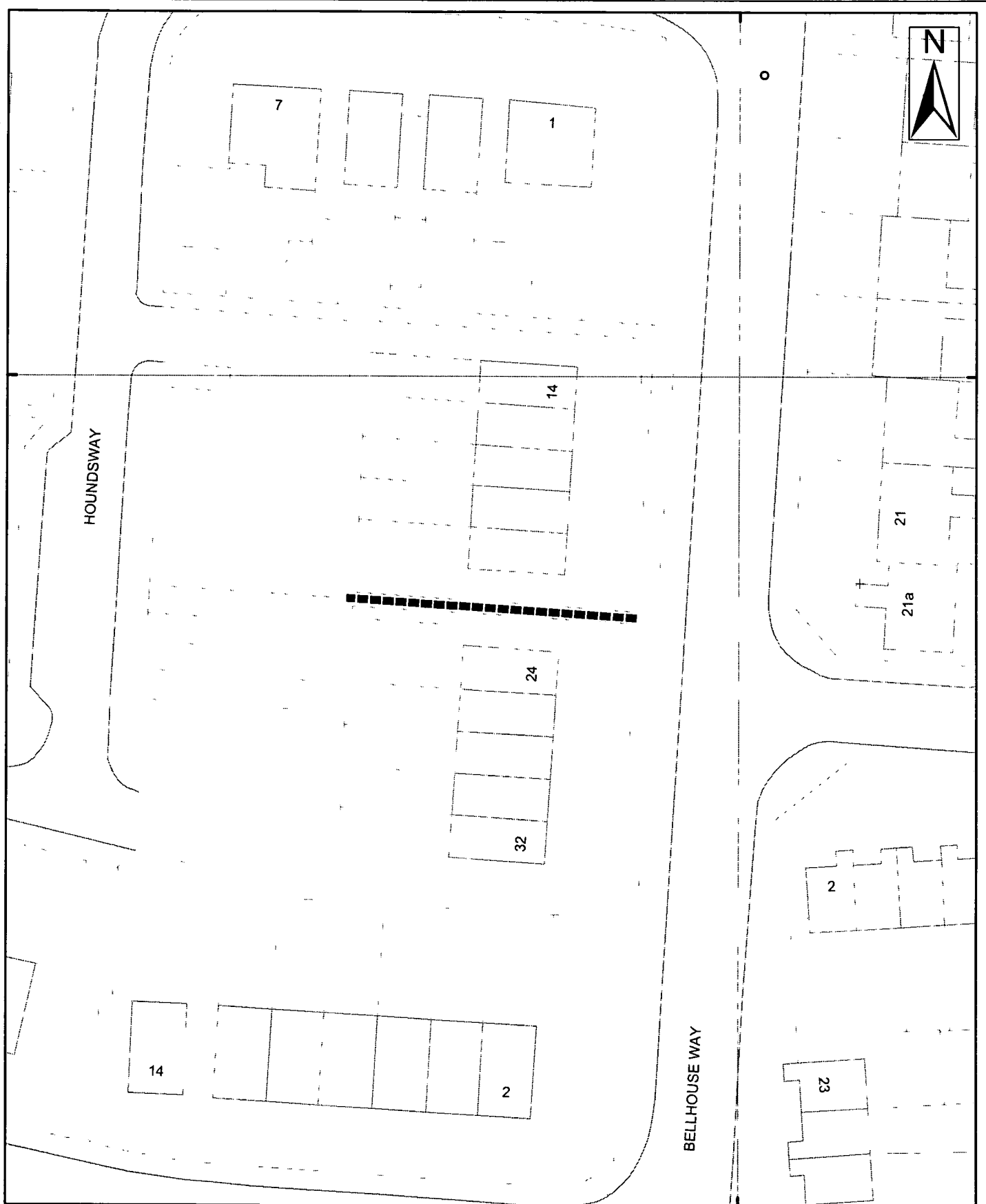

449900

BELLHOUSE WAY

HOUNDSWAY

456900



**York, Footpath No 97  
(Westfield Ward)**

Scale 1:481	Drawn By:	Date:
-------------	-----------	-------

Public Rights of Way	Reference:	Drawing No.
----------------------	------------	-------------

9 St. Leonards Place, York, YO1 2ET  
Telephone: 01904 613161

Reproduced from the Ordnance Survey with the permission of the Controller of Her Majesty's Stationery Office © Crown copyright. Unauthorised reproduction is prohibited and may lead to prosecution or civil proceedings. City of York Council 10000000

**Public Rights Of Way – Wildlife & Countryside Act 1981  
Preparation of Definitive Map Former County Borough of York – Westfield**

Schedule 33

**Ward:** Westfield  
**Status:** Public Footpath  
**Path No:** 98 (Westfield)

**Description of route**

Footpath running from side of 14 Bellhouse Way into Houndsway

**Approximate length**

30 Metres

**Nature of Surface:**

<u>Start Grid Reference</u>	<u>End Grid Reference</u>	<u>Surface Type</u>
SE 5689 4990	SE 5686 4990	Paved

**Approximate Width:**

<u>Start Grid Reference</u>	<u>End Grid Reference</u>	<u>Width</u>
SE 5689 4990	SE 5686 4990	1m

**Structures: (Stiles, Gates and Bridges etc)**

<u>Structure</u>	<u>Grid Reference</u>	<u>Structure Reference</u>
------------------	-----------------------	----------------------------

**Evidence Summary etc**

Documentary Evidence etc	Yes	No	Date (if applicable)	Other Information
OS Plans	✓		1987	
Inclosure				
Tithe				
1910 Finance Act				
Rights of Way Act 1932				
Railway/Canal Plans				
Other Maps				
User Evidence				
Photographs	✓			Taken as part of CYC surveys

Utility Companies Affected	Yes	No	Date (if applicable)	Other Information
British Gas		✓		
BT		✓		
Cable & Wireless		✓		
Northern Electric		✓		
NTL Network Services		✓		
Torch Telecom		✓		
Yorkshire Water		✓		
York Waterworks		✓		

**Recommendation:**

Make Order to add route to Definitive Map and Statement



456900

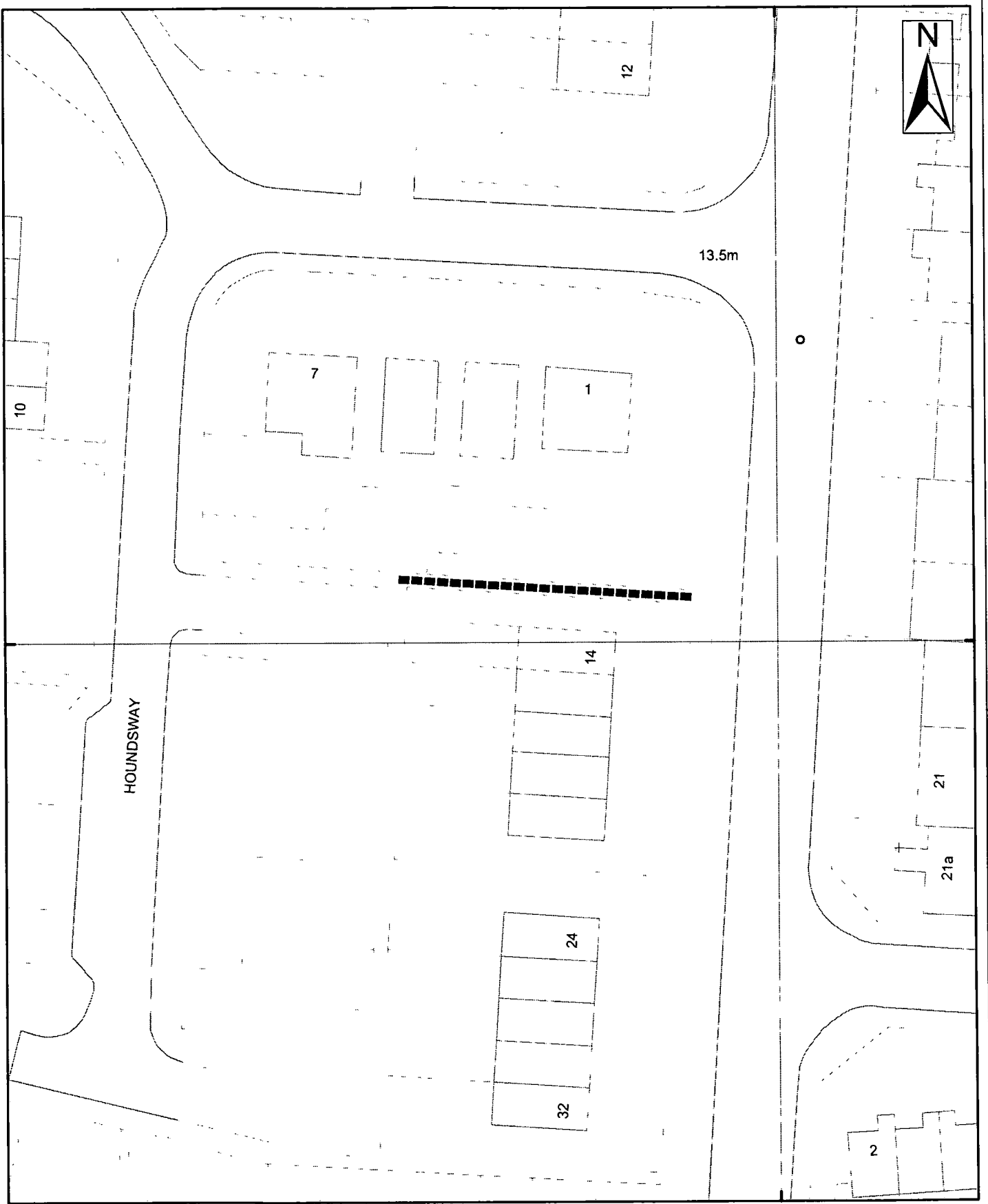

o



HOUNDSDWAY

13.5m

7

12

14

21

21a

24

32

3

10

456900

**York, Footpath No 98  
(Westfield Ward)**

Scale 1:481

Drawn By:

Date:

Public Rights of Way

Reference:

Drawing No.



9 St. Leonards Place, York, YO1 2ET  
Telephone: 01904 613161

Reproduced from the Ordnance Survey with the permission of the Controller of Her Majesty's Stationery Office © Crown copyright.  
Unauthorized reproduction infringes Crown copyright and may lead to proceedings for civil and criminal offences. City of York Council 10/2008/10

449900

449900

449900

449900

449900

449900

**Public Rights Of Way – Wildlife & Countryside Act 1981  
Preparation of Definitive Map Former County Borough of York – Westfield**

Schedule 34

**Ward:** Westfield  
**Status:** Public Footpath  
**Path No:** 99 (Westfield)

**Description of route**

Footpath running from side of 58 Foxwood Lane south to rear of 6 Bellhouse Way

**Approximate length**

25 Metres

**Nature of Surface:**

<u>Start Grid Reference</u>	<u>End Grid Reference</u>	<u>Surface Type</u>
SE 5687 4999	SE 5686 4996	Paved

**Approximate Width:**

<u>Start Grid Reference</u>	<u>End Grid Reference</u>	<u>Width</u>
SE 5687 4999	SE 5686 4996	1m

**Structures: (Stiles, Gates and Bridges etc)**

<u>Structure</u>	<u>Grid Reference</u>	<u>Structure Reference</u>
------------------	-----------------------	----------------------------

**Evidence Summary etc**

Documentary Evidence etc	Yes	No	Date (if applicable)	Other Information
OS Plans	✓		1987	
Inclosure				
Tithe				
1910 Finance Act				
Rights of Way Act 1932				
Railway/Canal Plans				
Other Maps				
User Evidence				
Photographs	✓			Taken as part of CYC surveys

Utility Companies Affected	Yes	No	Date (if applicable)	Other Information
British Gas		✓		
BT		✓		
Cable & Wireless		✓		
Northern Electric		✓		
NTL Network Services		✓		
Torch Telecom		✓		
Yorkshire Water		✓		
York Waterworks		✓		

**Recommendation:**

Make Order to add route to Definitive Map and Statement

456900

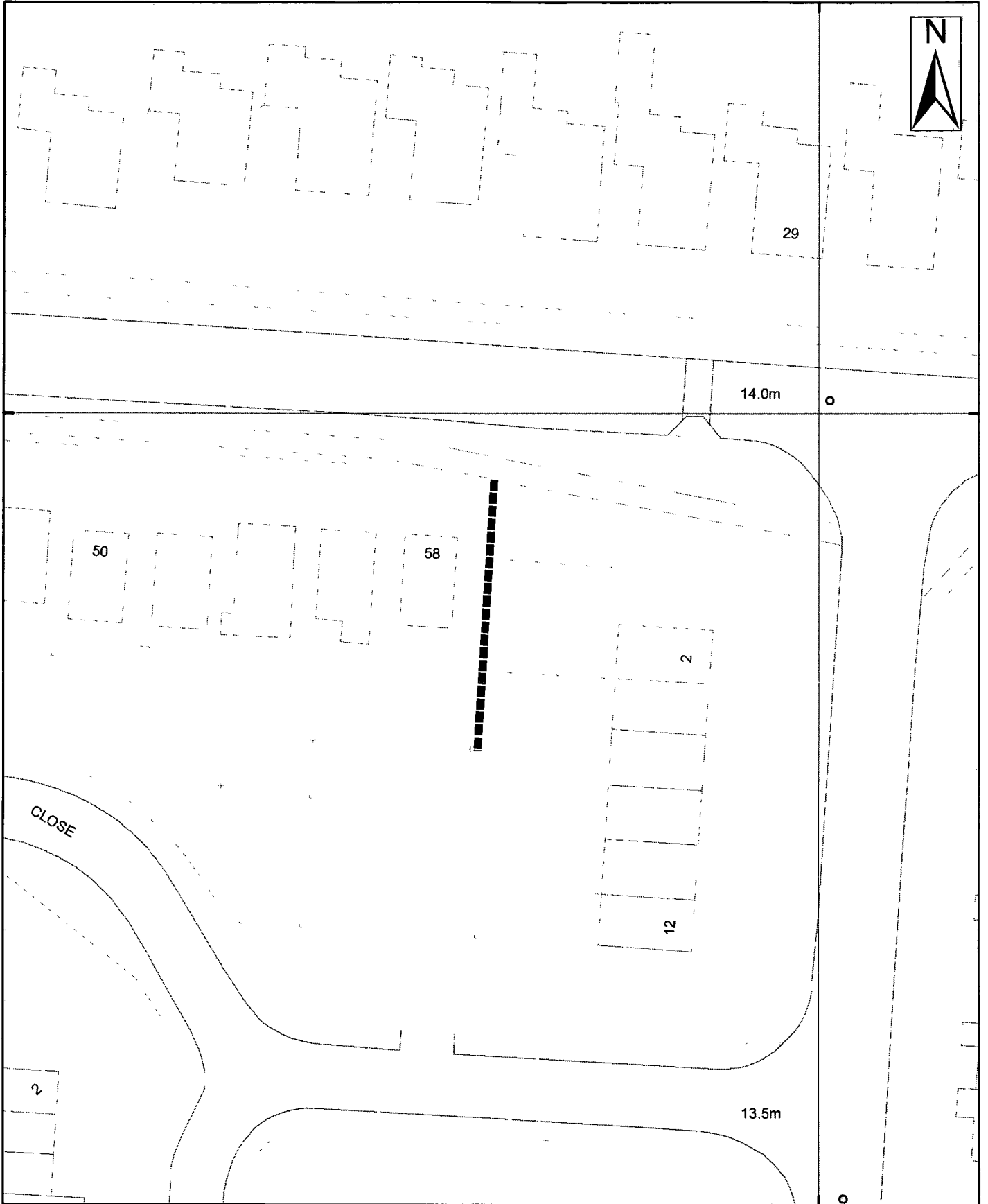

456900

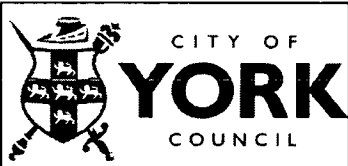

9 St. Leonards Place, York, YO1 2ET  
Telephone: 01904 613161

### York, Footpath No 99 (Westfield Ward)

Scale 1:481

Drawn By:

Date:

Public Rights of Way

Reference:

Drawing No.

Reproduced from the Ordnance Survey with the permission of the Controller of Her Majesty's Stationery Office © Crown copyright.  
Unauthorized reproduction infringes Crown copyright and may lead to prosecution or civil proceedings. City of York Council 100000818

**Public Rights Of Way – Wildlife & Countryside Act 1981  
Preparation of Definitive Map Former County Borough of York – Westfield**

Schedule 35

**Ward:** Westfield  
**Status:** Public Footpath  
**Path No:** 100 (Westfield)

**Description of route**

Path running from Hawkshead Close between numbers 13 & 14 to meet York 59 in Acomb Wood.

**Approximate length**

33 Metres

**Nature of Surface:**

<u>Start Grid Reference</u>	<u>End Grid Reference</u>	<u>Surface Type</u>
SE 5681 4955	SE 5681 4952	Natural

**Approximate Width:**

<u>Start Grid Reference</u>	<u>End Grid Reference</u>	<u>Width</u>
SE 5681 4955	SE 5681 4952	2m

**Structures: (Stiles, Gates and Bridges etc)**

<u>Structure</u>	<u>Grid Reference</u>	<u>Structure Reference</u>
Kissing gate	SE 5681 4954	Y100b

**Evidence Summary etc**

Documentary Evidence etc	Yes	No	Date (if applicable)	Other Information
OS Plans	✓		1987	
Inclosure				
Tithe				
1910 Finance Act				
Rights of Way Act 1932				
Railway/Canal Plans				
Other Maps				
User Evidence				
Photographs	✓			Taken as part of CYC surveys

Utility Companies Affected	Yes	No	Date (if applicable)	Other Information
British Gas		✓		
BT		✓		
Cable & Wireless		✓		
Northern Electric		✓		
NTL Network Services		✓		
Torch Telecom		✓		
Yorkshire Water		✓		
York Waterworks		✓		

**Recommendation:**

Make Order to add route to Definitive Map and Statement

456800 000000

449600

449600

449500

449500



449600 000000

449500 000000

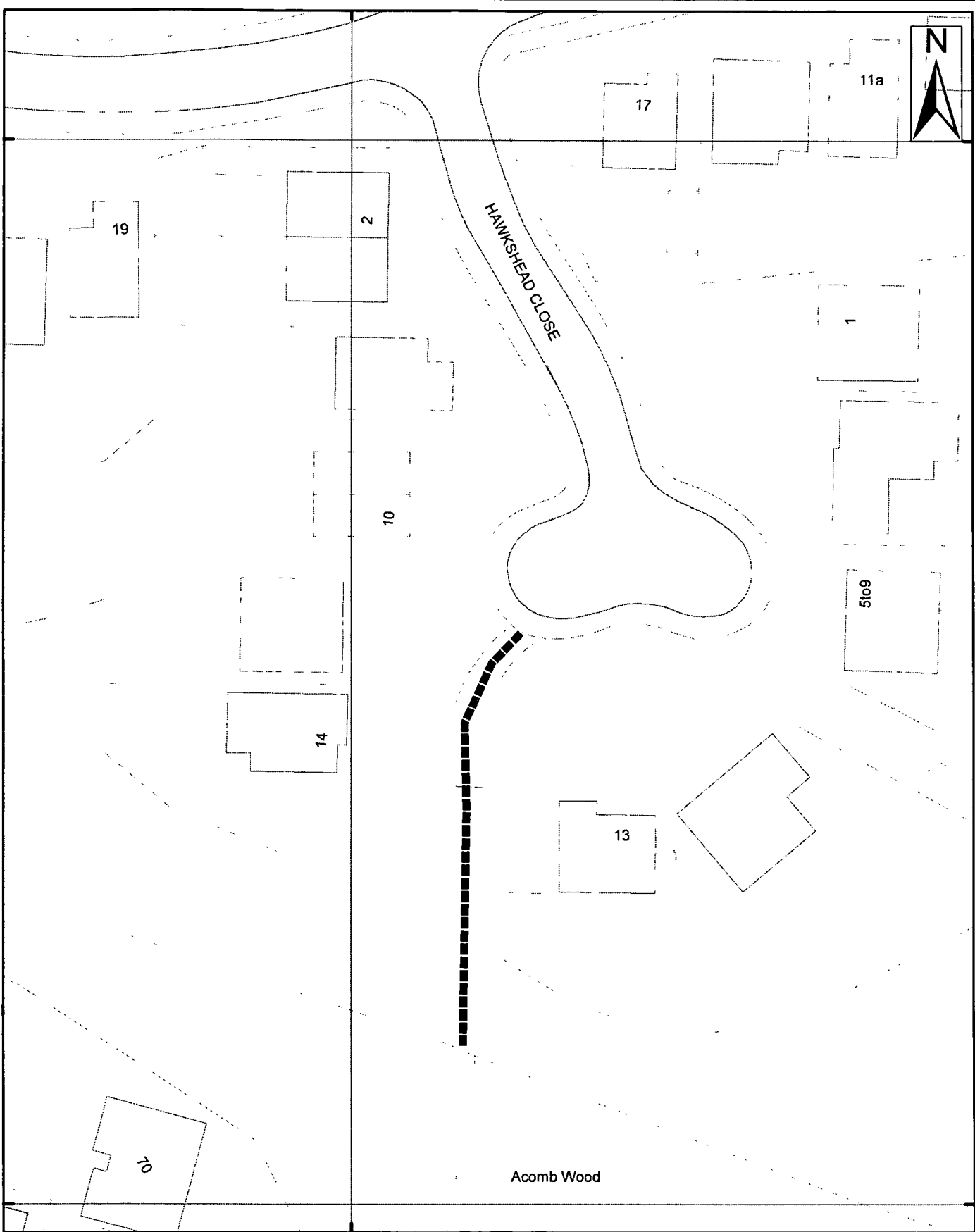

456800 000000



9 St. Leonards Place, York, YO1 2ET  
Telephone: 01904 613161

### York, Footpath No 100 (Westfield Ward)

Scale 1:500

Drawn By:

Date:

Public Rights of Way

Reference:

Drawing No.

Reproduced from the Ordnance Survey with the permission of the Controller of Her Majesty's Stationery Office © Crown copyright.  
Unauthorized reproduction infringes Crown copyright and may lead to prosecution or civil proceedings. City of York Council 100020R18

**Public Rights Of Way – Wildlife & Countryside Act 1981  
Preparation of Definitive Map Former County Borough of York – Westfield**

Schedule 36

**Ward:** Westfield  
**Status:** Public Footpath  
**Path No:** 101 (Westfield)

**Description of route**

Footpath running from Osprey Close between 36 & 29 through a gate onto a field. The path runs north over a viewpoint known as Great Knoll before descending to terminate on Foxwood Road

**Approximate length**

450 Metres

**Nature of Surface:**

<u>Start Grid Reference</u>	<u>End Grid Reference</u>	<u>Surface Type</u>
SE 5675 4961	SE 5673 4962	Tarmac
SE 5673 4962	SE 5661 4999	Natural

**Approximate Width:**

<u>Start Grid Reference</u>	<u>End Grid Reference</u>	<u>Width</u>
SE 5675 4961	SE 5673 4962	3m
SE 5673 4962	SE 5661 4999	1m

**Structures: (Stiles, Gates and Bridges etc)**

<u>Structure</u>	<u>Grid Reference</u>	<u>Structure Reference</u>
Kissing gate	SE 5673 4962	Y101a
Remains of stile	SE 5668 4968	Y101d
Stile	SE 5661 4999	Y101f

**Evidence Summary etc**

Documentary Evidence etc	Yes	No	Date (if applicable)	Other Information
OS Plans				
Inclosure				
Tithe				
1910 Finance Act				
Rights of Way Act 1932				
Railway/Canal Plans				
Other Evidence				Aerial Photograph
User Evidence				
Photographs	✓			Taken as part of CYC surveys

Utility Companies Affected	Yes	No	Date (if applicable)	Other Information
British Gas		✓		
BT		✓		
Cable & Wireless				
Northern Electric		✓		
NTL Network Services		✓		
Torch Telecom		✓		
Yorkshire Water		✓		
York Waterworks		✓		

**Recommendation:**

Make Order to add route to Definitive Map and Statement

456500 000000

456600 000000

456700 000000

456800 000000

456900 000000

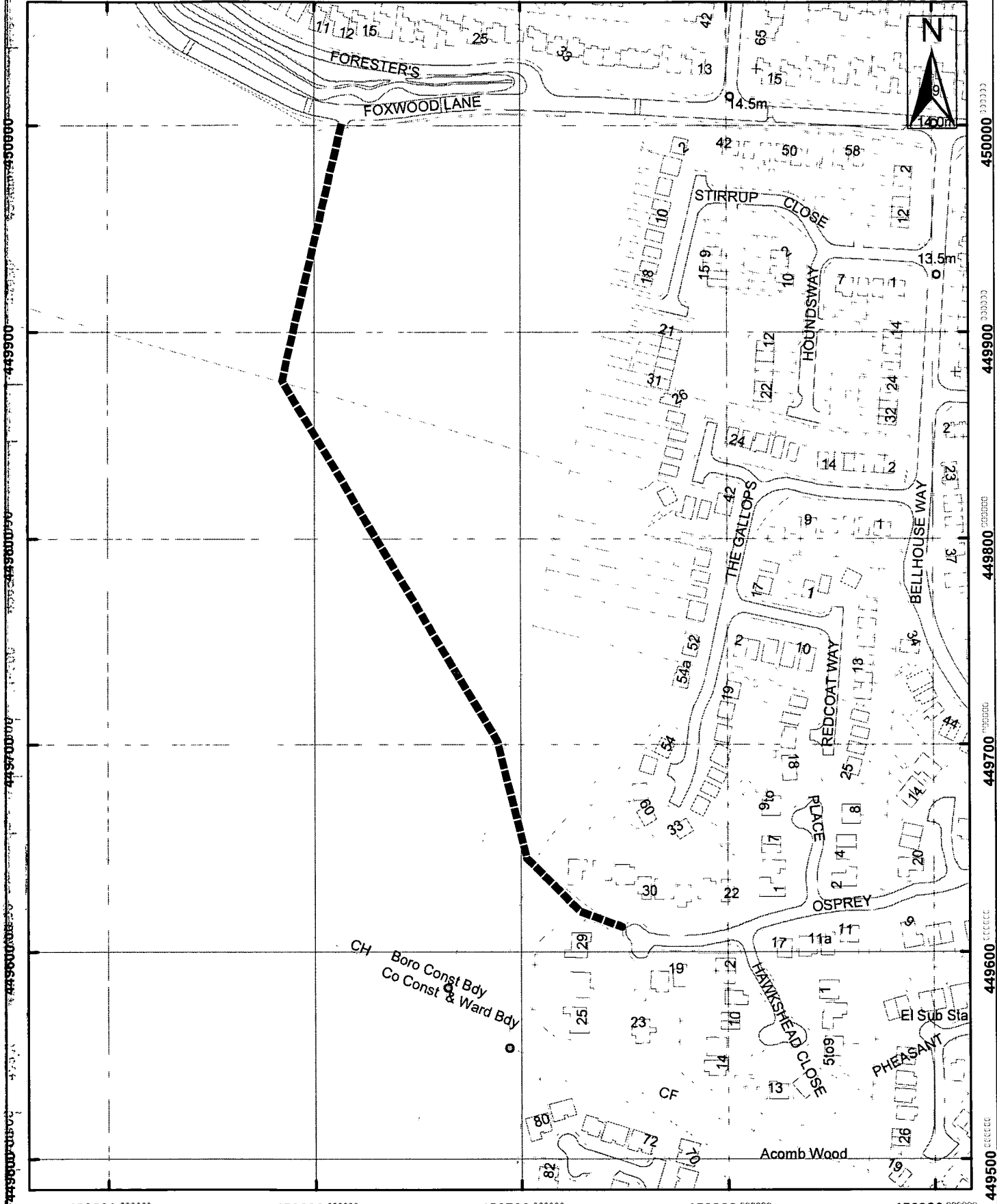

456500 000000

456600 000000

456700 000000

456800 000000

456900 000000



9 St. Leonards Place, York, YO1 2ET  
 Telephone: 01904 613161

### York, Footpath No 101 (Westfield Ward)

Scale 1:2,500

Drawn By:

Date:

Public Rights of Way

Reference:

Drawing No.

Reproduced from the Ordnance Survey with the permission of the Controller of Her Majesty's Stationery Office © Crown copyright.  
 Unauthorised reproduction infringes Crown copyright and may lead to prosecution or civil proceedings. City of York Council 10020818

**Public Rights Of Way – Wildlife & Countryside Act 1981  
Preparation of Definitive Map Former County Borough of York – Westfield**

Schedule 37

**Ward:** Westfield  
**Status:** Public Footpath  
**Path No:** 102 (Westfield)

**Description of route**

From end of Askham Grove in a south easterly direction to Tennent Road.

**Approximate length**

38 Metres

**Nature of Surface:**

<u>Start Grid Reference</u>	<u>End Grid Reference</u>	<u>Surface Type</u>
SE 5686 5060	SE 5689 5058	Paved

**Approximate Width:**

<u>Start Grid Reference</u>	<u>End Grid Reference</u>	<u>Width</u>
SE 5686 5060	SE 5689 5058	1.3m

**Structures: (Stiles, Gates and Bridges etc)**

<u>Structure</u>	<u>Grid Reference</u>	<u>Structure Reference</u>
steps	SE 5686 5060	Y102b
steps	SE 5689 5058	Y102a

**Evidence Summary etc**

Documentary Evidence etc	Yes	No	Date (if applicable)	Other Information
OS Plans	✓		1987	
Inclosure				
Tithe				
1910 Finance Act				
Rights of Way Act 1932				
Railway/Canal Plans				
Other Maps				
User Evidence				
Photographs	✓			Taken as part of CYC surveys

Utility Companies Affected	Yes	No	Date (if applicable)	Other Information
British Gas		✓		
BT		✓		
Cable & Wireless		✓		
Northern Electric		✓		
NTL Network Services		✓		
Torch Telecom		✓		
Yorkshire Water		✓		
York Waterworks		✓		

**Recommendation:**

Make Order to add route to Definitive Map and Statement



456800 000000

456900 000000

450700

450700

450600

450600

450500

450500

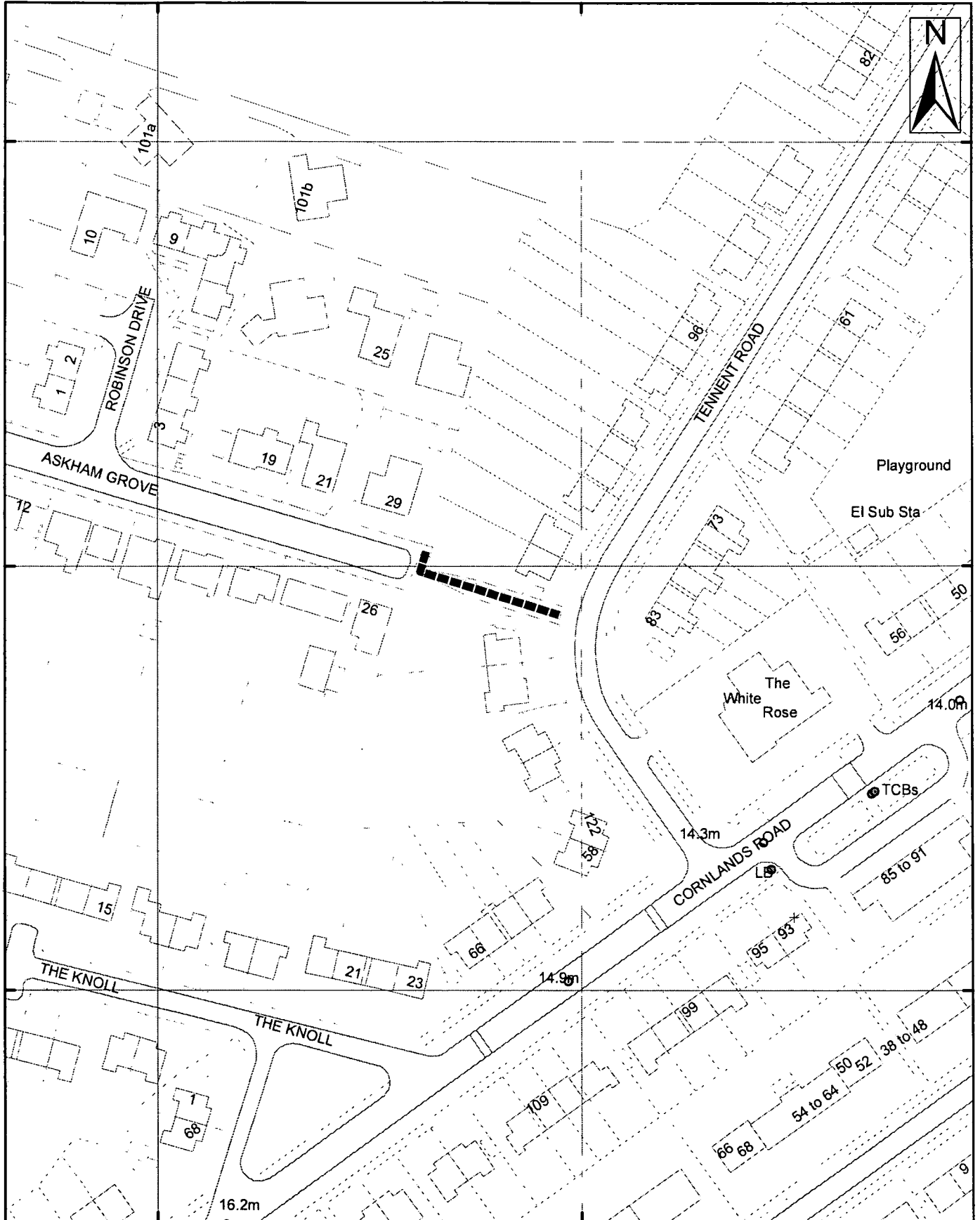

456800 000000

456900 000000



### York, Footpath No 102 (Westfield Ward)

Scale 1:1,250

Drawn By:

Date:

Public Rights of Way

Reference:

Drawing No.

9 St. Leonards Place, York, YO1 2ET  
Telephone: 01904 613161

Reproduced from the Ordnance Survey with the permission of the Controller of Her Majesty's Stationery Office © Crown copyright.  
Unauthorized reproduction infringes Crown copyright and may lead to prosecution or civil proceedings. City of York Council 100020818

**Public Rights Of Way – Wildlife & Countryside Act 1981  
Preparation of Definitive Map Former County Borough of York – Westfield**

Schedule 38

**Ward:** Westfield  
**Status:** Public Footpath  
**Path No:** 103 (Westfield)

**Description of route**

Footpath running from a point between nos 71 & 73 Tennent Road south easterly to Cornlands Road between The White Rose public house and no 56 Cornlands Road.

**Approximate length**

72 Metres

**Nature of Surface:**

<u>Start Grid Reference</u>	<u>End Grid Reference</u>	<u>Surface Type</u>
SE 5693 5062	SE 5697 5056	Paved

**Approximate Width:**

<u>Start Grid Reference</u>	<u>End Grid Reference</u>	<u>Width</u>
SE 5693 5062	SE 5697 5056	1.2m

**Structures: (Stiles, Gates and Bridges etc)**

<u>Structure</u>	<u>Grid Reference</u>	<u>Structure Reference</u>
------------------	-----------------------	----------------------------

**Evidence Summary etc**

Documentary Evidence etc	Yes	No	Date (if applicable)	Other Information
OS Plans	✓		1987	
Inclosure				
Tithe				
1910 Finance Act				
Rights of Way Act 1932				
Railway/Canal Plans				
Other Maps				
User Evidence				
Photographs	✓			Taken as part of CYC surveys

Utility Companies Affected	Yes	No	Date (if applicable)	Other Information
British Gas		✓		
BT		✓		
Cable & Wireless		✓		
Northern Electric		✓		
NTL Network Services		✓		
Torch Telecom		✓		
Yorkshire Water		✓		
York Waterworks		✓		

**Recommendation:**

Make Order to add route to Definitive Map and Statement

456900 000000

457000 000000

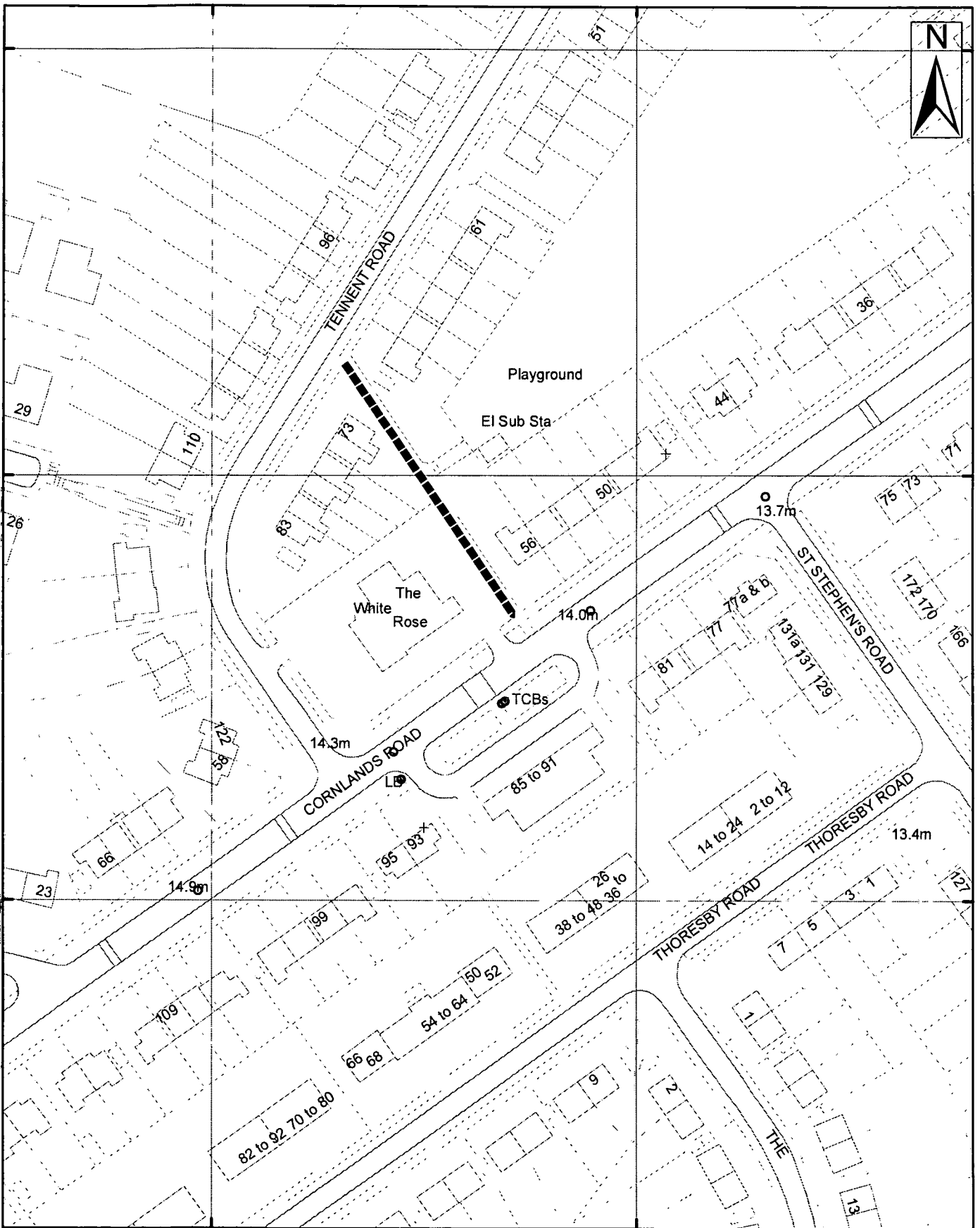

456900 000000

457000 000000



9 St. Leonards Place, York, YO1 2ET  
 Telephone: 01904 613161

### York, Footpath No 103 (Westfield Ward)

Scale 1:1,250

Drawn By:

Date:

Public Rights of Way

Reference:

Drawing No.

Reproduced from the Ordnance Survey with the permission of the Controller of Her Majesty's Stationery Office © Crown copyright.  
 Unauthorised reproduction infringes Crown copyright and may lead to prosecution or civil proceedings. City of York Council 10020R18

**Public Rights Of Way – Wildlife & Countryside Act 1981  
Preparation of Definitive Map Former County Borough of York – Westfield**

Schedule 39

**Ward:** Westfield  
**Status:** Public Footpath  
**Path No:** 104 (Westfield)

**Description of route**

Footpath running from Tennent Road between nos 59 & 61 in a south easterly direction to emerge on Cornlands Road between nos 44 & 46.

**Approximate length**

87 Metres

**Nature of Surface:**

<u>Start Grid Reference</u>	<u>End Grid Reference</u>	<u>Surface Type</u>
SE 5696 5067	SE 5698 5065	Tarmac
SE 5698 5065	SE 5700 5062	Grass
SE 5700 5062	SE 5701 5060	Tarmac

**Approximate Width:**

<u>Start Grid Reference</u>	<u>End Grid Reference</u>	<u>Width</u>
SE 5696 5067	SE 5698 5065	1.5m
SE 5698 5065	SE 5700 5062	Undefined
SE 5700 5062	SE 5701 5060	1.5m

**Structures: (Stiles, Gates and Bridges etc)**

<u>Structure</u>	<u>Grid Reference</u>	<u>Structure Reference</u>
Cycle barrier	SE 5696 5067	Y104a

**Evidence Summary etc**

Documentary Evidence etc	Yes	No	Date (if applicable)	Other Information
OS Plans	✓		1987	
Inclosure				
Tithe				
1910 Finance Act				
Rights of Way Act 1932				
Railway/Canal Plans				
Other Maps				
User Evidence				
Photographs	✓			Taken as part of CYC surveys

Utility Companies Affected	Yes	No	Date (if applicable)	Other Information
British Gas		✓		
BT		✓		
Cable & Wireless		✓		
Northern Electric		✓		
NTL Network Services		✓		
Torch Telecom		✓		
Yorkshire Water		✓		
York Waterworks		✓		

**Recommendation:**

Make Order to add route to Definitive Map and Statement

456900 000000

457000 000000

457100 000000

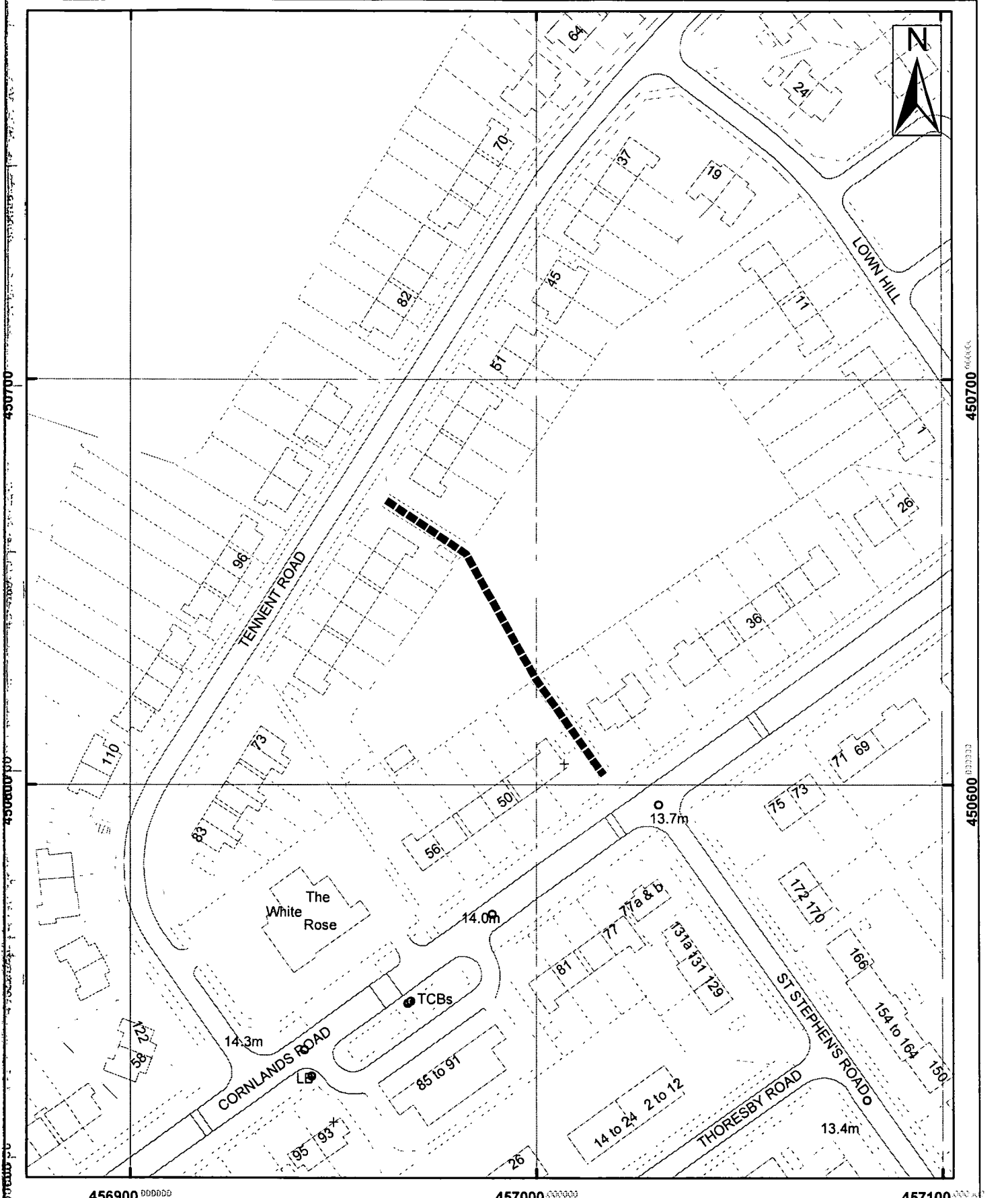

456900 000000

457000 000000

457100 000000

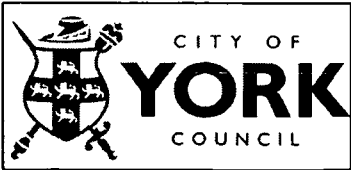

9 St. Leonards Place, York, YO1 2ET  
 Telephone: 01904 613161

### York, Footpath No 104 (Westfield Ward)

Scale 1:1,250	Drawn By:	Date:
Public Rights of Way	Reference:	Drawing No.

Reproduced from the Ordnance Survey with the permission of the Controller of Her Majesty's Stationery Office © Crown copyright. Unauthorised reproduction infringes Crown copyright and may lead to prosecution or civil proceedings. City of York Council 10002081A

**Public Rights Of Way – Wildlife & Countryside Act 1981  
Preparation of Definitive Map Former County Borough of York – Westfield**

Schedule 40

**Ward:** Westfield  
**Status:** Public Footpath  
**Path No:** 105 (Westfield)

**Description of route**

Footpath commencing between 71a & 73 Askham Lane and running in a southerly direction across Batchelor Hill Park to Tennent Road between 84 & 86.

**Approximate length**

250 Metres

**Nature of Surface:**

<u>Start Grid Reference</u>	<u>End Grid Reference</u>	<u>Surface Type</u>
SE 5678 5086	SE 5682 5085	SE Tarmac
SE 5682 5085	SE 5696 5070	SE Natural

**Approximate Width:**

<u>Start Grid Reference</u>	<u>End Grid Reference</u>	<u>Width</u>
SE 5678 5086	SE 5682 5085	1.5m
SE 5682 5085	SE 5694 5071	undefined
SE 5694 5071	SE 5696 5070	1.5m

**Structures: (Stiles, Gates and Bridges etc)**

<u>Structure</u>	<u>Grid Reference</u>	<u>Structure Reference</u>
Kissing gate	SE 5682 5085	Y105b
Steps	SE 5695 5071	Y105c
Kissing gate	SE 5696 5071	Y105c

**Evidence Summary etc**

Documentary Evidence etc	Yes	No	Date (if applicable)	Other Information
OS Plans				
Inclosure				
Tithe				
1910 Finance Act				
Rights of Way Act 1932				
Railway/Canal Plans				
Other Maps				
User Evidence	✓			1 forms
Photographs	✓			Taken as part of CYC surveys

Utility Companies Affected	Yes	No	Date (if applicable)	Other Information
British Gas		✓		
BT		✓		
Cable & Wireless				
Northern Electric		✓		
NTL Network Services		✓		
Torch Telecom		✓		
Yorkshire Water		✓		
York Waterworks		✓		

**Recommendation:**

Make Order to add route to Definitive Map and Statement

456700

456800

456900

457000

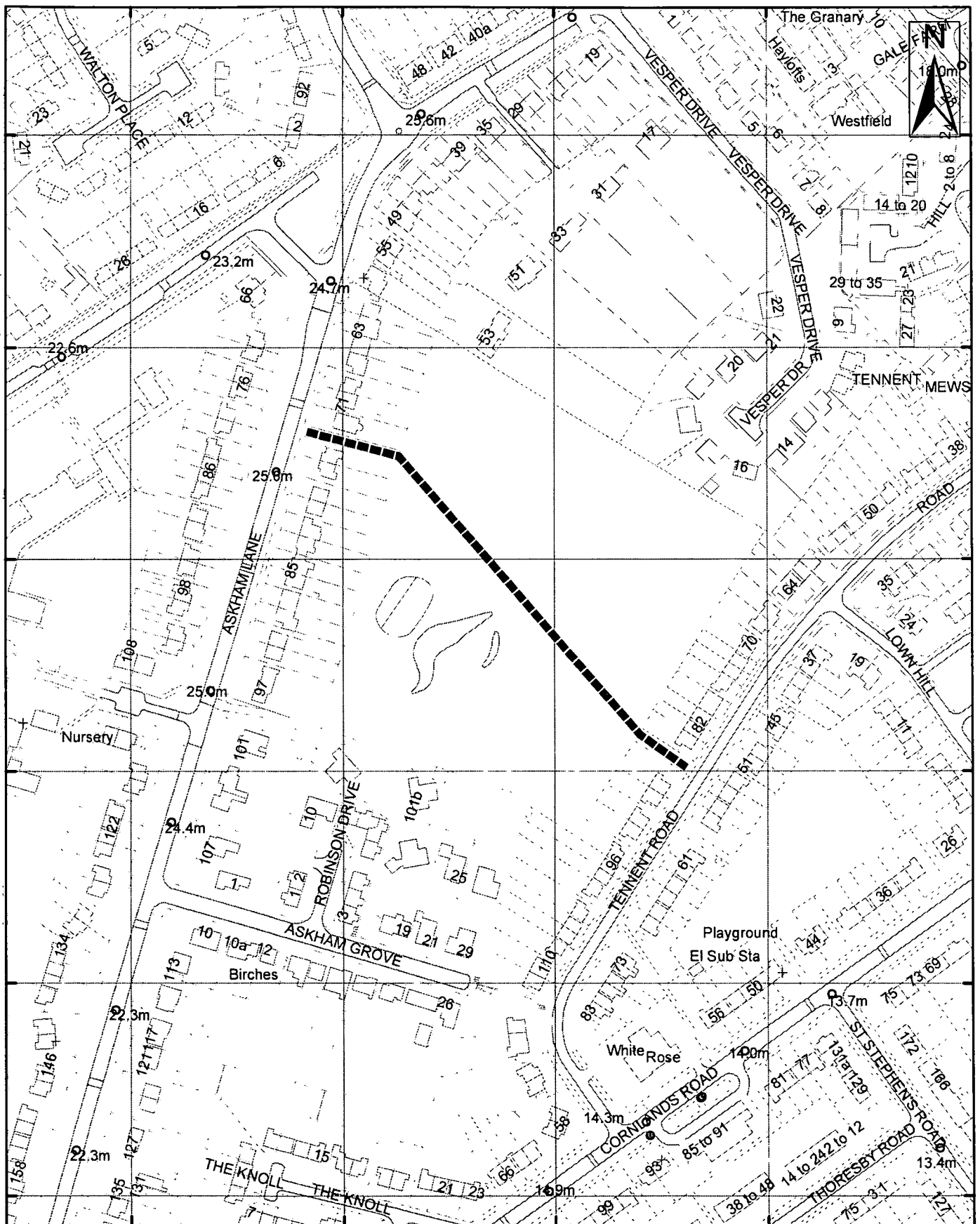

456700

456800

456900

457000



9 St. Leonards Place, York, YO1 2ET  
 Telephone: 01904 613161

### York, Footpath No 105 (Westfield Ward)

Scale 1:2,500

Drawn By:

Date:

Public Rights of Way

Reference:

Drawing No.

Reproduced from the Ordnance Survey with the permission of the Controller of Her Majesty's Stationery Office © Crown copyright.  
 Unauthorised reproduction infringes Crown copyright and may lead to prosecution or civil proceedings. City of York Council 100020818

**Public Rights Of Way – Wildlife & Countryside Act 1981  
Preparation of Definitive Map Former County Borough of York – Westfield**

Schedule 41

**Ward:** Westfield  
**Status:** Public Footpath  
**Path No:** 106 (Westfield)

**Description of route**

Footpath commencing between 30a & 28b Westfield Place and running to eastwards the to garages behind.

**Approximate length**

33 Metres

**Nature of Surface:**

<u>Start Grid Reference</u>	<u>End Grid Reference</u>	<u>Surface Type</u>
SE 5649 5049	SE 5652 5048	Tarmac

**Approximate Width:**

<u>Start Grid Reference</u>	<u>End Grid Reference</u>	<u>Width</u>
SE 5649 5049	SE 5652 5048	4m

**Structures: (Stiles, Gates and Bridges etc)**

<u>Structure</u>	<u>Grid Reference</u>	<u>Structure Reference</u>
------------------	-----------------------	----------------------------

**Evidence Summary etc**

Documentary Evidence etc	Yes	No	Date (if applicable)	Other Information
OS Plans	✓		1994	
Inclosure				
Tithe				
1910 Finance Act				
Rights of Way Act 1932				
Railway/Canal Plans				
Other Maps				
User Evidence				
Photographs	✓			Taken as part of CYC surveys
<b>Utility Companies Affected</b>				
British Gas		✓		
BT		✓		
Cable & Wireless				
Northern Electric		✓		
NTL Network Services		✓		
Torch Telecom		✓		
Yorkshire Water	✓			
York Waterworks		✓		

**Recommendation:**

Make Order to add route to Definitive Map and Statement



456500

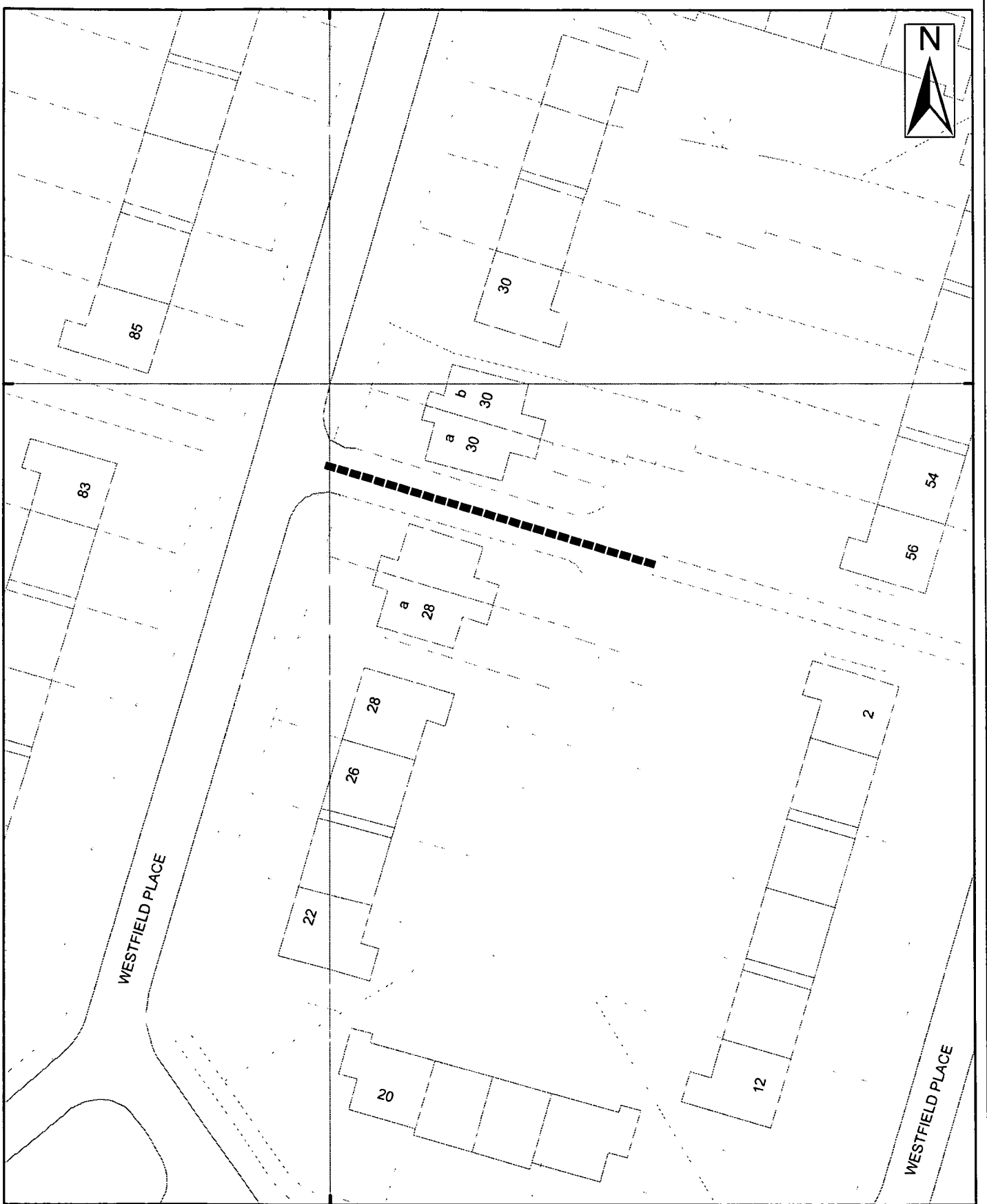

456500



9 St. Leonards Place, York, YO1 2ET  
Telephone: 01904 613161

### York, Footpath No106 (Westfield Ward)

Scale 1:500

Drawn By:

Date:

Public Rights of Way

Reference:

Drawing No.

Reproduced from the Ordnance Survey with the permission of the Controller of Her Majesty's Stationery Office © Crown copyright.

**Public Rights Of Way – Wildlife & Countryside Act 1981  
Preparation of Definitive Map Former County Borough of York – Westfield**

Schedule 42

**Ward:** Westfield  
**Status:** Public Footpath  
**Path No:** 107 (Westfield)

**Description of route**

Footpath running from Grange Lane opposite Bramham Road south across fields to the footway running between 83 & 85 Westfield Place

**Approximate length**

342 Metres

**Nature of Surface:**

<u>Start Grid Reference</u>	<u>End Grid Reference</u>	<u>Surface Type</u>
SE 5647 5084	SE 5647 5083	Tarmac
SE 5647 5083	SE 5648 5050	Natural

**Approximate Width:**

<u>Start Grid Reference</u>	<u>End Grid Reference</u>	<u>Width</u>
SE 5647 5084	SE 5647 5083	1m
SE 5647 5083	SE 5648 5050	Undefined

**Structures: (Stiles, Gates and Bridges etc)**

<u>Structure</u>	<u>Grid Reference</u>	<u>Structure Reference</u>
Cycle barrier	SE 5644 5069	Y107c
Vehicle gate	SE 5645 5050	Y107a

**Evidence Summary etc**

Documentary Evidence etc	Yes	No	Date (if applicable)	Other Information
OS Plans				
Inclosure				
Tithe				
1910 Finance Act				
Rights of Way Act 1932				
Railway/Canal Plans				
Other Maps				
User Evidence	✓			1 user evidence form
Photographs	✓			Taken as part of CYC surveys

Utility Companies Affected	Yes	No	Date (if applicable)	Other Information
British Gas		✓		
BT		✓		
Cable & Wireless				
Northern Electric	✓			
NTL Network Services		✓		
Torch Telecom		✓		
Yorkshire Water	✓			
York Waterworks		✓		

**Recommendation:**

Make Order to add route to Definitive Map and Statement

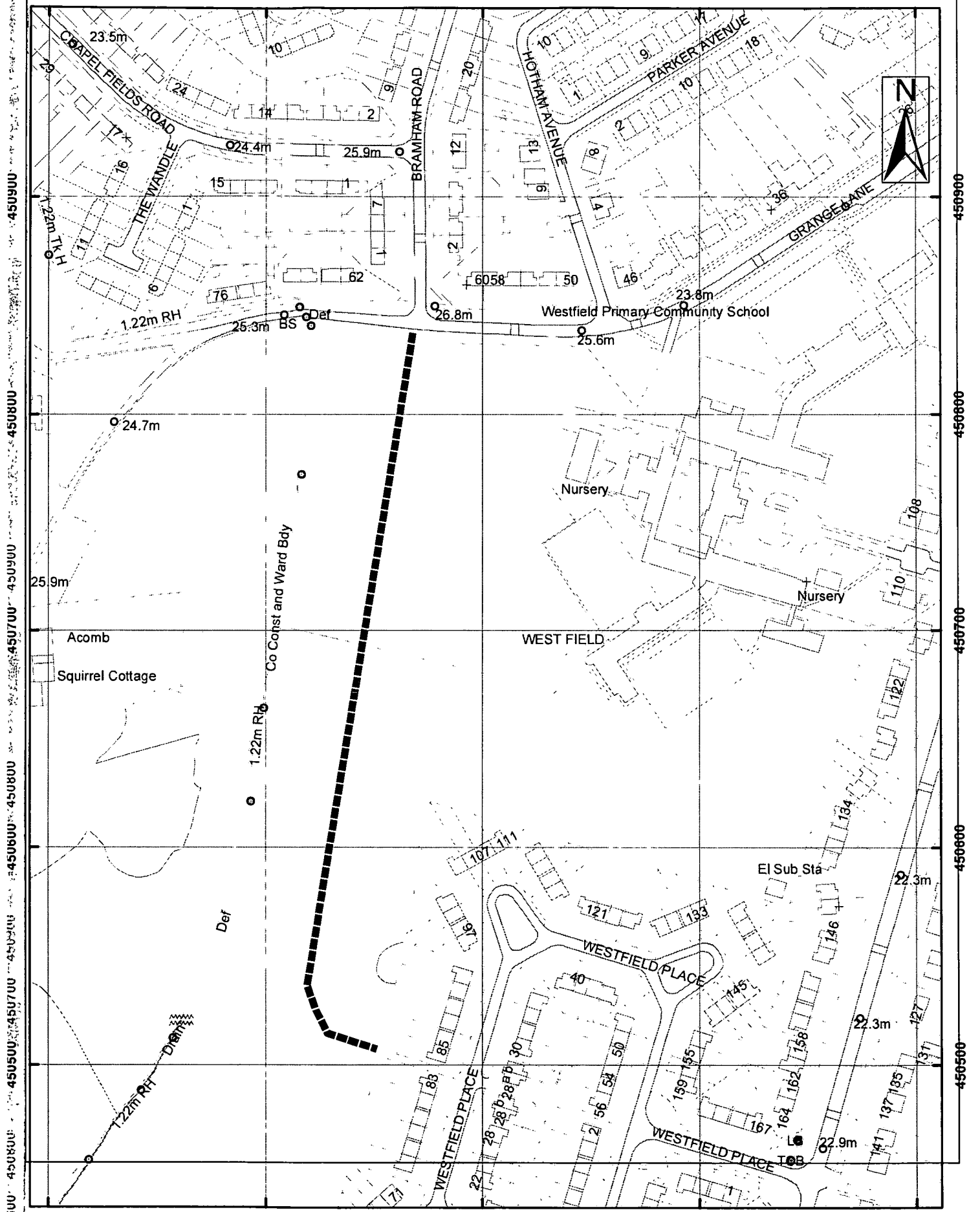

450900 450800 450700 450600 450500 450400 450300 450200 450100 450000  
 456300 456400 456500 456600 456700



## York, Footpath No107 (Westfield Ward)

Scale 1:2,250	Drawn By:	Date:
Public Rights of Way	Reference:	Drawing No.

9 St. Leonards Place, York, YO1 2ET  
 Telephone: 01904 613161

Reproduced from the Ordnance Survey with the permission of the Controller of Her Majesty's Stationery Office © Crown copyright.  
 Unauthorised reproduction in any form is prohibited. City of York Council 10000000

**Public Rights Of Way – Wildlife & Countryside Act 1981  
Preparation of Definitive Map Former County Borough of York – Westfield**

Schedule 43

**Ward:** Westfield  
**Status:** Public Footpath  
**Path No:** 108 (Westfield)

**Description of route**

Footpath running between 7 & 9 Chapel Fields Road then south past the garages to emerge between 70 & 68 Grange Lane

**Approximate length**

64 Metres

**Nature of Surface:**

<u>Start Grid Reference</u>	<u>End Grid Reference</u>	<u>Surface Type</u>
SE 5640 5091	SE 5640 5085	Tarmac

**Approximate Width:**

<u>Start Grid Reference</u>	<u>End Grid Reference</u>	<u>Width</u>
SE 5640 5091	SE 5640 5085	1.5 – 2.5m

**Structures: (Stiles, Gates and Bridges etc)**

<u>Structure</u>	<u>Grid Reference</u>	<u>Structure Reference</u>
------------------	-----------------------	----------------------------

**Evidence Summary etc**

Documentary Evidence etc	Yes	No	Date (if applicable)	Other Information
OS Plans	✓		1994	
Inclosure				
Tithe				
1910 Finance Act				
Rights of Way Act 1932				
Railway/Canal Plans				
Other Maps				
User Evidence				
Photographs	✓			Taken as part of CYC surveys

Utility Companies Affected	Yes	No	Date (if applicable)	Other Information
British Gas		✓		
BT		✓		
Cable & Wireless				
Northern Electric	✓			
NTL Network Services		✓		
Torch Telecom		✓		
Yorkshire Water		✓		
York Waterworks		✓		

**Recommendation:**

Make Order to add route to Definitive Map and Statement



**Public Rights Of Way – Wildlife & Countryside Act 1981  
Preparation of Definitive Map Former County Borough of York – Westfield**

Schedule 44

**Ward:** Westfield  
**Status:** Public Footpath  
**Path No:** 109 (Westfield)

**Description of route**

Footpath commencing at the side of 142 Wetherby Road and running south westerly to the rear of 153 Chapelfields Road then turning south easterly to Chapelfields Road, between No 151 & 153.

**Approximate length**

135 Metres

**Nature of Surface:**

<u>Start Grid Reference</u>	<u>End Grid Reference</u>	<u>Surface Type</u>
SE 5631 5146	SE 5629 5134	Tarmac

**Approximate Width:**

<u>Start Grid Reference</u>	<u>End Grid Reference</u>	<u>Width</u>
SE 5631 5146	SE 5629 5134	1.3m

**Structures: (Stiles, Gates and Bridges etc)**

<u>Structure</u>	<u>Grid Reference</u>	<u>Structure Reference</u>
Cycle barrier & 3 concrete bollards	SE 5631 5146	Y109b

**Evidence Summary etc**

Documentary Evidence etc	Yes	No	Date (if applicable)	Other Information
OS Plans	✓		1929, 1958 & 2000	
Inclosure				
Tithe				
1910 Finance Act				
Rights of Way Act 1932				
Railway/Canal Plans				
Other Maps				
User Evidence	✓			10 forms
Photographs	✓			Taken as part of CYC surveys

Utility Companies Affected	Yes	No	Date (if applicable)	Other Information
British Gas		✓		
BT	✓			
Cable & Wireless				
Northern Electric	✓			
NTL Network Services		✓		
Torch Telecom		✓		
Yorkshire Water		✓		
York Waterworks	✓			

**Recommendation:**

Make Order to add route to Definitive Map and Statement

Co Const & Ward Bdy



451500

451500

451400

451400

451300

451300

456200

456300

456400



### York, Footpath No109 (Westfield Ward)

Scale 1:1,250

Drawn By:

Date:

Public Rights of Way

Reference:

Drawing No.

9 St. Leonards Place, York, YO1 2ET  
Telephone: 01904 613161

Reproduced from the Ordnance Survey with the permission of the Controller of Her Majesty's Stationery Office © Crown copyright.

00000000

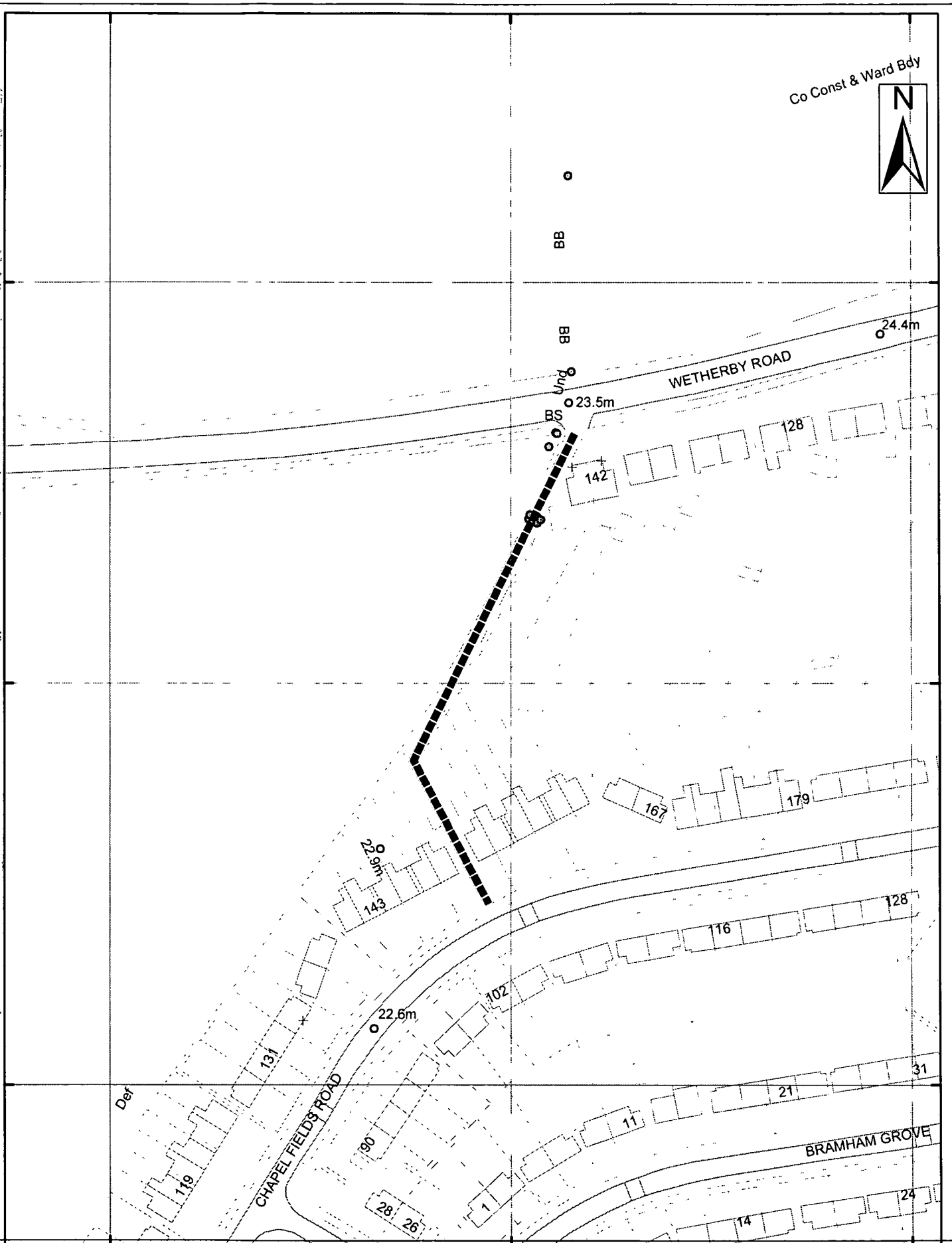

**Public Rights Of Way – Wildlife & Countryside Act 1981  
Preparation of Definitive Map Former County Borough of York – Westfield**

Schedule 45

**Ward:** Westfield  
**Status:** Public Footpath  
**Path No:** 110 (Westfield)

**Description of route**

Footpath running south across Acomb Green from Wetherby Road then up steps to the Friends Meeting House.

**Approximate length**

80 Metres

**Nature of Surface:**

<u>Start Grid Reference</u>	<u>End Grid Reference</u>	<u>Surface Type</u>
SE 5712 5138	SE 5714 5130	Paved

**Approximate Width:**

<u>Start Grid Reference</u>	<u>End Grid Reference</u>	<u>Width</u>
SE 5712 5138	SE 5714 5130	1m

**Structures: (Stiles, Gates and Bridges etc)**

<u>Structure</u>	<u>Grid Reference</u>	<u>Structure Reference</u>
Steps at either end	SE 5712 5138	Y110b
Concrete bollard x2:	SE 5714 5130	Y110a
Steps	SE 5714 5130	Y110a

**Evidence Summary etc**

Documentary Evidence etc	Yes	No	Date (if applicable)	Other Information
OS Plans	✓		1968	
Inclosure				
Tithe				
1910 Finance Act				
Rights of Way Act 1932				
Railway/Canal Plans				
Other Maps				
User Evidence	✓			10 forms
Photographs	✓			Taken as part of CYC surveys

Utility Companies Affected	Yes	No	Date (if applicable)	Other Information
British Gas		✓		
BT		✓		
Cable & Wireless				
Northern Electric		✓		
NTL Network Services		✓		
Torch Telecom		✓		
Yorkshire Water		✓		
York Waterworks		✓		

**Recommendation:**

Make Order to add route to Definitive Map and Statement



457100 000000

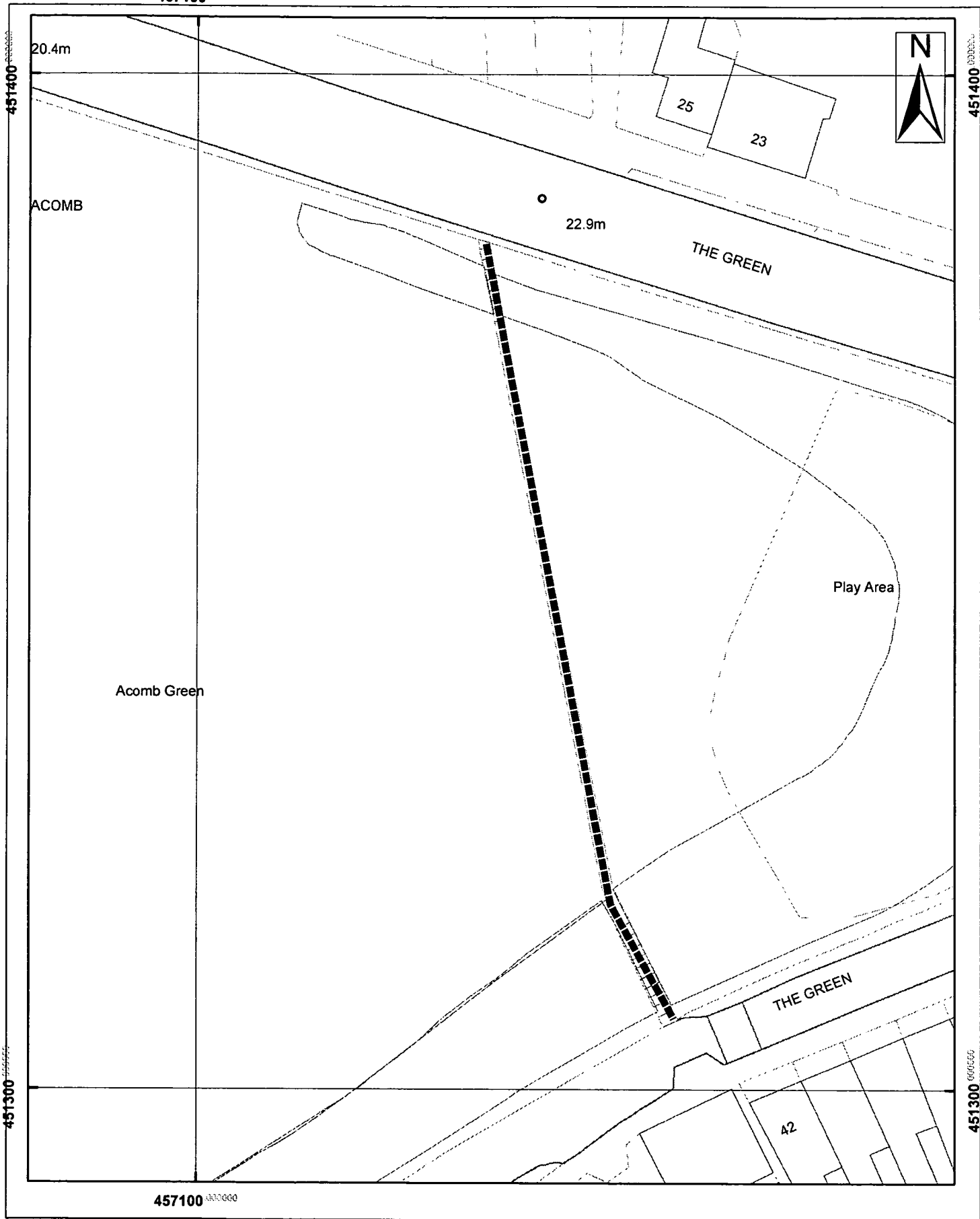

9 St. Leonards Place, York, YO1 2ET  
 Telephone: 01904 613161

### York, Footpath No 110 (Westfield Ward)

Scale 1:500	Drawn By:	Date:
Public Rights of Way	Reference:	Drawing No.

Reproduced from the Ordnance Survey with the permission of the Controller of Her Majesty's Stationery Office © Crown copyright.  
 Unauthorised reproduction infringes Crown copyright and may lead to prosecution or civil proceedings. City of York Council 100020818

**Public Rights Of Way – Wildlife & Countryside Act 1981  
Preparation of Definitive Map Former County Borough of York – Westfield**

Schedule 46

**Ward:** Westfield  
**Status:** Public Footpath  
**Path No:** 111 (Westfield)

**Description of route**

Footpath running from a point opposite 52 Lowfields Avenue to Morrisons car park

**Approximate length**

49 Metres

**Nature of Surface:**

<u>Start Grid Reference</u>	<u>End Grid Reference</u>	<u>Surface Type</u>
SE 5739 5112	SE 5742 5114	Concrete
SE 5742 5114	SE 5743 5115	Tarmac

**Approximate Width:**

<u>Start Grid Reference</u>	<u>End Grid Reference</u>	<u>Width</u>
SE 5739 5112	SE 5742 5114	1m
SE 5742 5114	SE 5743 5115	1.5m

**Structures: (Stiles, Gates and Bridges etc)**

<u>Structure</u>	<u>Grid Reference</u>	<u>Structure Reference</u>
------------------	-----------------------	----------------------------

**Evidence Summary etc**

Documentary Evidence etc	Yes	No	Date (if applicable)	Other Information
OS Plans	✓		1982	
Inclosure				
Tithe				
1910 Finance Act				
Rights of Way Act 1932				
Railway/Canal Plans				
Other Maps				
User Evidence				
Photographs	✓			Taken as part of CYC surveys

Utility Companies Affected	Yes	No	Date (if applicable)	Other Information
British Gas		✓		
BT		✓		
Cable & Wireless				
Northern Electric		✓		
NTL Network Services		✓		
Torch Telecom		✓		
Yorkshire Water		✓		
York Waterworks		✓		

**Recommendation:**

Make Order to add route to Definitive Map and Statement

457400 000000

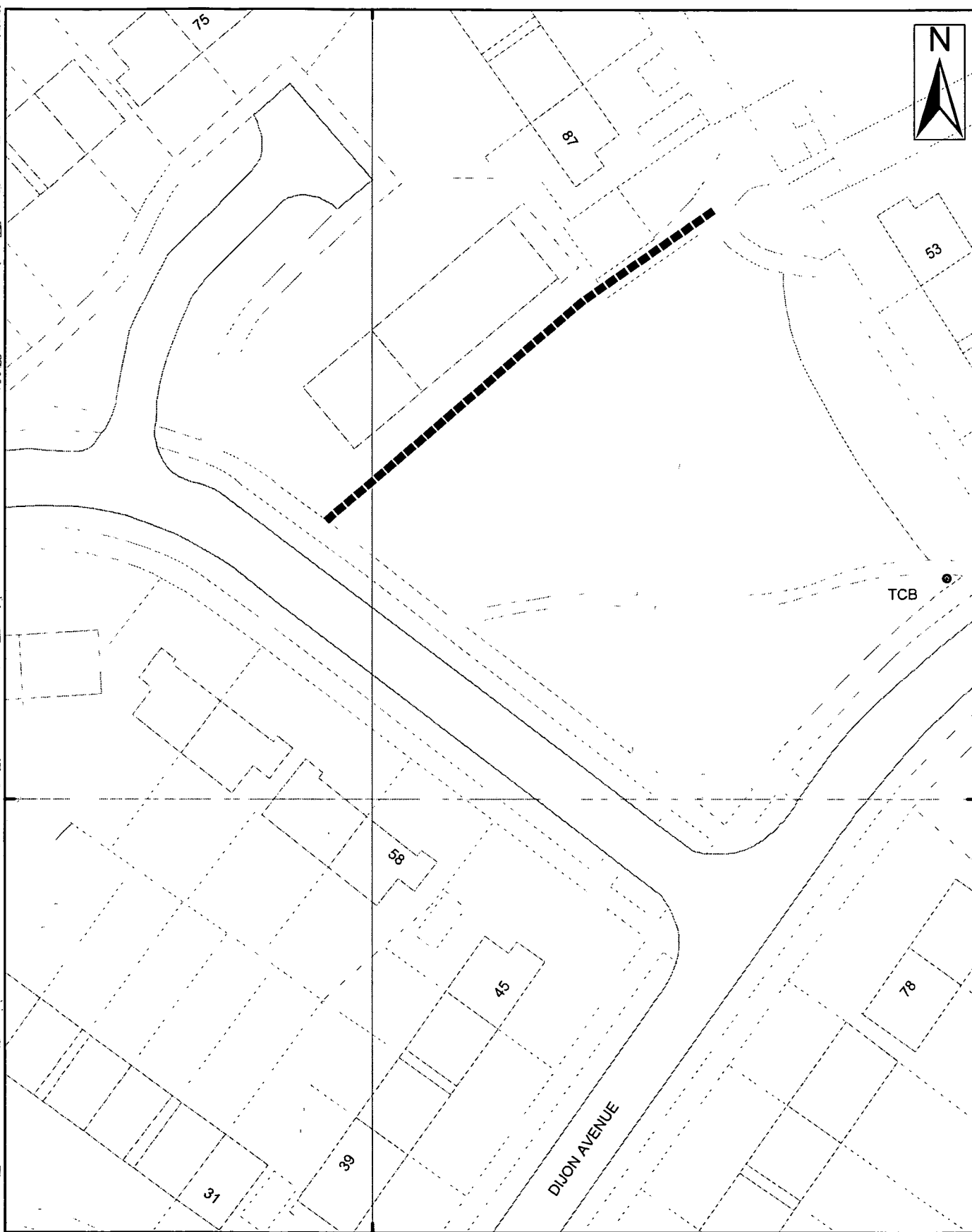

457400 000000



9 St. Leonards Place, York, YO1 2ET  
Telephone: 01904 613161

### York, Footpath No 111 (Westfield Ward)

Scale 1:500

Drawn By:

Date:

Public Rights of Way

Reference:

Drawing No.

Reproduced from the Ordnance Survey with the permission of the Controller of Her Majesty's Stationery Office © Crown copyright.  
Unauthorized reproduction infringes Crown copyright and may lead to prosecution or civil proceedings. City of York Council 100020818

451100 000000

**Public Rights Of Way – Wildlife & Countryside Act 1981  
Preparation of Definitive Map Former County Borough of York – Westfield**

Schedule 47

**Ward:** Westfield  
**Status:** Public Footpath  
**Path No:** 112 (Westfield)

**Description of route**

Footpath running eastwards cutting the corner of Dijon Avenue and Lowfields Drive.

**Approximate length**

49 Metres

**Nature of Surface:**

<u>Start Grid Reference</u>	<u>End Grid Reference</u>	<u>Surface Type</u>
SE 5740 5111	SE 5745 5112	Concrete

**Approximate Width:**

<u>Start Grid Reference</u>	<u>End Grid Reference</u>	<u>Width</u>
SE 5740 5111	SE 5745 5112	1m

**Structures: (Stiles, Gates and Bridges etc)**

<u>Structure</u>	<u>Grid Reference</u>	<u>Structure Reference</u>
------------------	-----------------------	----------------------------

**Evidence Summary etc**

Documentary Evidence etc	Yes	No	Date (if applicable)	Other Information
OS Plans	✓		1968 & 1982	
Inclosure				
Tithe				
1910 Finance Act				
Rights of Way Act 1932				
Railway/Canal Plans				
Other Maps				
User Evidence				
Photographs	✓			Taken as part of CYC surveys

Utility Companies Affected	Yes	No	Date (if applicable)	Other Information
British Gas		✓		
BT		✓		
Cable & Wireless				
Northern Electric		✓		
NTL Network Services		✓		
Torch Telecom		✓		
Yorkshire Water		✓		
York Waterworks		✓		

**Recommendation:**

Make Order to add route to Definitive Map and Statement

457400 000000

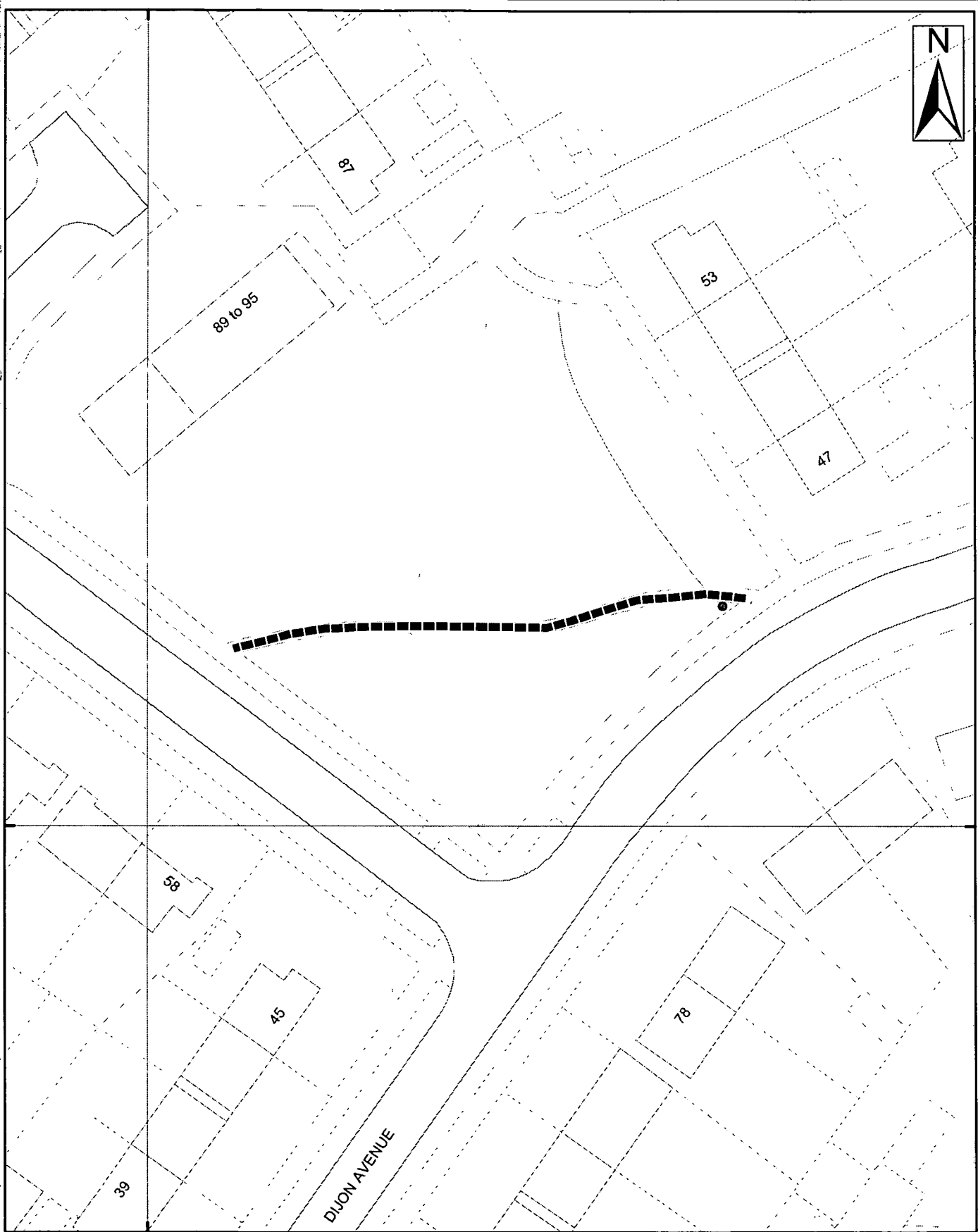

451100 000000

451100 000000

457400 000000



9 St. Leonards Place, York, YO1 2ET  
Telephone: 01904 613161

### York, Footpath No 112 (Westfield Ward)

Scale 1:500

Drawn By:

Date:

Public Rights of Way

Reference:

Drawing No.

Reproduced from the Ordnance Survey with the permission of the Controller of Her Majesty's Stationery Office © Crown copyright.  
Unauthorized reproduction infringes Crown copyright and may lead to prosecution or civil proceedings. City of York Council 100020818

**Public Rights Of Way – Wildlife & Countryside Act 1981  
Preparation of Definitive Map Former County Borough of York – Westfield**

Schedule 48

**Ward:** Westfield  
**Status:** Public Footpath  
**Path No:** 113 (Westfield)

**Description of route**

Footpath running north across grass area from corner of Dijon Avenue and Lowfields Drive to Morrisons car park.

**Approximate length**

57 Metres

**Nature of Surface:**

<u>Start Grid Reference</u>	<u>End Grid Reference</u>	<u>Surface Type</u>
SE 5742 5110	SE 5743 5115	Tarmac

**Approximate Width:**

<u>Start Grid Reference</u>	<u>End Grid Reference</u>	<u>Width</u>
SE 5742 5110	SE 5743 5115	1.2m

**Structures: (Stiles, Gates and Bridges etc)**

<u>Structure</u>	<u>Grid Reference</u>	<u>Structure Reference</u>
------------------	-----------------------	----------------------------

**Evidence Summary etc**

Documentary Evidence etc	Yes	No	Date (if applicable)	Other Information
OS Plans	✓		1968 & 1982	
Inclosure				
Tithe				
1910 Finance Act				
Rights of Way Act 1932				
Railway/Canal Plans				
Other Maps				
User Evidence				
Photographs	✓			Taken as part of CYC surveys
<b>Utility Companies Affected</b>				
British Gas		✓		
BT		✓		
Cable & Wireless				
Northern Electric		✓		
NTL Network Services		✓		
Torch Telecom		✓		
Yorkshire Water		✓		
York Waterworks		✓		

**Recommendation:**

Make Order to add route to Definitive Map and Statement

457400 000000

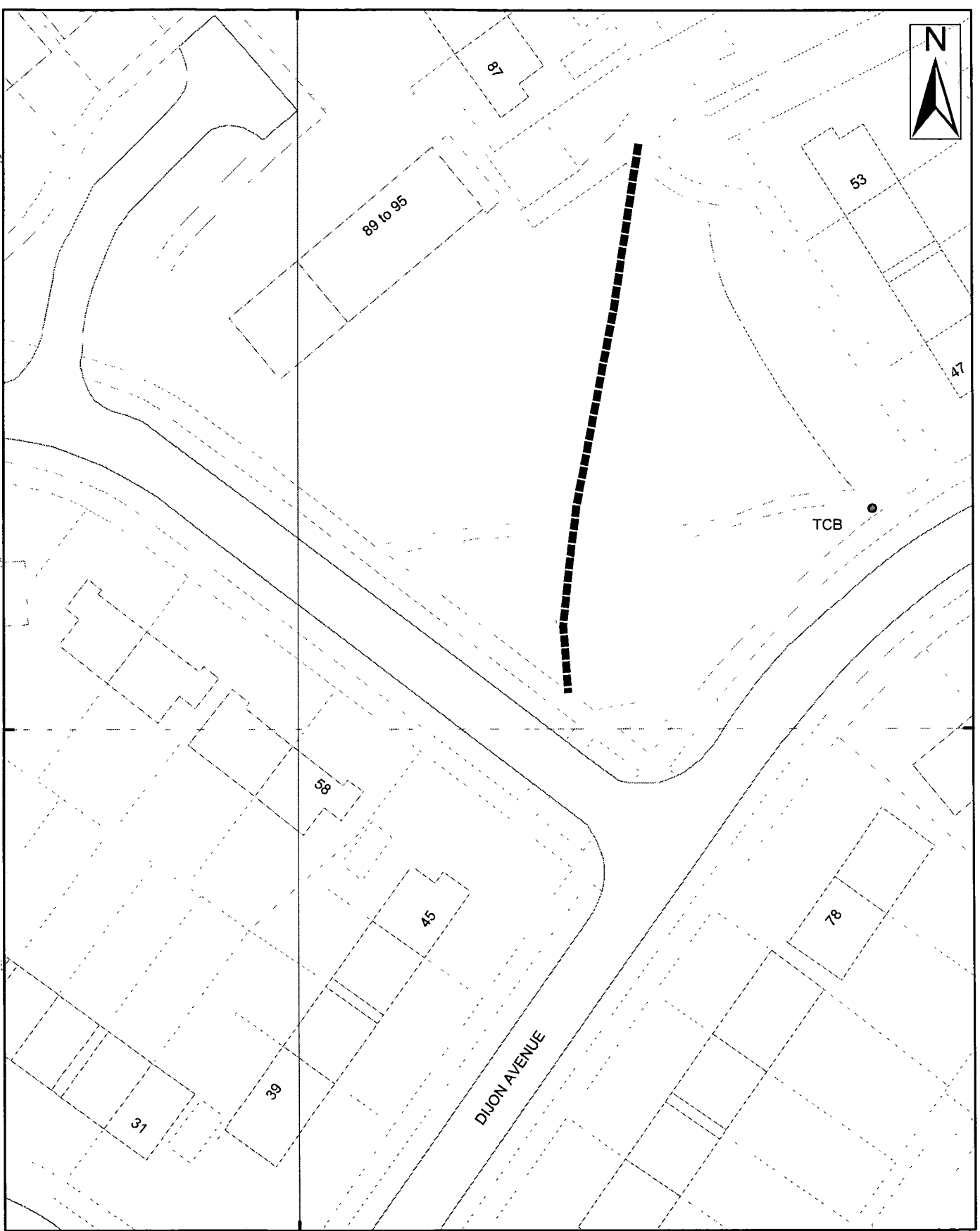

457400 000000



9 St. Leonards Place, York, YO1 2ET  
 Telephone: 01904 613161

### York, Footpath No 113 (Westfield Ward)

Scale 1:500	Drawn By:	Date:
Public Rights of Way	Reference:	Drawing No.

Reproduced from the Ordnance Survey with the permission of the Controller of Her Majesty's Stationery Office © Crown copyright.  
 Unauthorised reproduction infringes Crown copyright and may lead to prosecution or civil proceedings. City of York Council 100020818

**Public Rights Of Way – Wildlife & Countryside Act 1981  
Preparation of Definitive Map Former County Borough of York – Westfield**

Schedule 49

**Ward:** Westfield  
**Status:** Public Footpath  
**Path No:** 114 (Westfield)

**Description of route**

Footpath running north westerly from 47 Dijon Avenue to Morrisons car park

**Approximate length**

43 Metres

**Nature of Surface:**

<u>Start Grid Reference</u>	<u>End Grid Reference</u>	<u>Surface Type</u>
SE 5746 5112	SE 5743 5115	Tarmac

**Approximate Width:**

<u>Start Grid Reference</u>	<u>End Grid Reference</u>	<u>Width</u>
SE 5746 5112	SE 5743 5115	1.2m

**Structures: (Stiles, Gates and Bridges etc)**

<u>Structure</u>	<u>Grid Reference</u>	<u>Structure Reference</u>
------------------	-----------------------	----------------------------

**Evidence Summary etc**

Documentary Evidence etc	Yes	No	Date (if applicable)	Other Information
OS Plans	✓		1982	
Inclosure				
Tithe				
1910 Finance Act				
Rights of Way Act 1932				
Railway/Canal Plans				
Other Maps				
User Evidence				
Photographs	✓			Taken as part of CYC surveys

Utility Companies Affected	Yes	No	Date (if applicable)	Other Information
British Gas		✓		
BT		✓		
Cable & Wireless				
Northern Electric	✓			
NTL Network Services		✓		
Torch Telecom		✓		
Yorkshire Water		✓		
York Waterworks		✓		

**Recommendation:**

Make Order to add route to Definitive Map and Statement



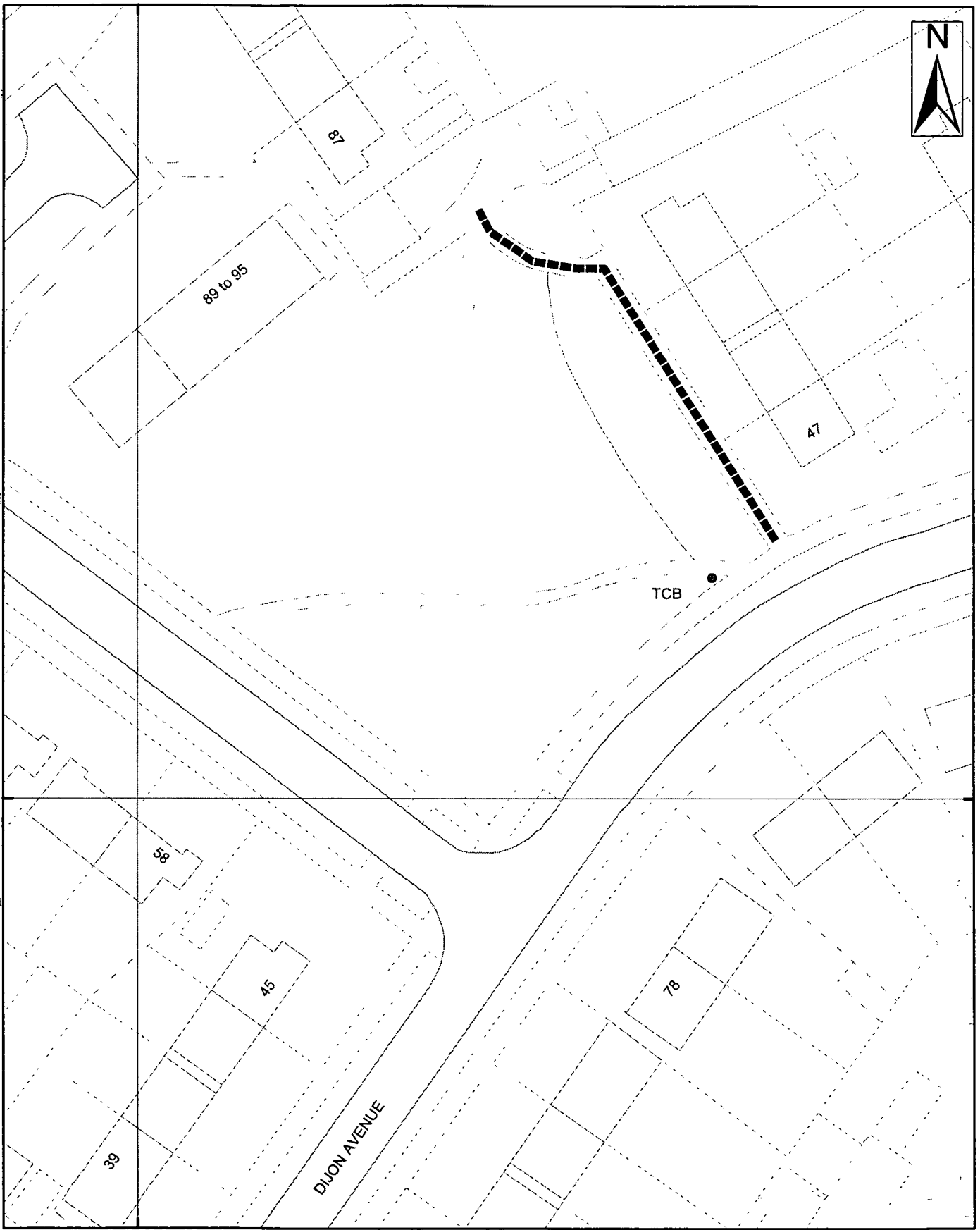

9 St. Leonards Place, York, YO1 2ET  
Telephone: 01904 613161

### York, Footpath No 114 (Westfield Ward)

Scale 1:500	Drawn By:	Date:
Public Rights of Way	Reference:	Drawing No.

Reproduced from the Ordnance Survey with the permission of the Controller of Her Majesty's Stationery Office © Crown copyright.  
Unauthorised reproduction infringes Crown copyright and may lead to prosecution or civil proceedings. City of York Council 100020818

**Public Rights Of Way – Wildlife & Countryside Act 1981  
Preparation of Definitive Map Former County Borough of York – Westfield**

Schedule 50

**Ward:** Westfield  
**Status:** Public Footpath  
**Path No:** 115 (Westfield)

**Description of route**

Footpath starting at side of 25 Kingsway West and running east to the car park and garages at the rear of 115 – 121 Green Lane

**Approximate length**

45 Metres

**Nature of Surface:**

<u>Start Grid Reference</u>	<u>End Grid Reference</u>	<u>Surface Type</u>
SE 5774 5077	SE 5779 5078	

**Approximate Width:**

<u>Start Grid Reference</u>	<u>End Grid Reference</u>	<u>Width</u>
SE 5774 5077	SE 5779 5078	

**General:**

Unusable as it is obstructed at side of 23 KWW (Y115)

**Structures: (Stiles, Gates and Bridges etc)**

<u>Structure</u>	<u>Grid Reference</u>	<u>Structure Reference</u>

**Evidence Summary etc**

Documentary Evidence etc	Yes	No	Date (if applicable)	Other Information
OS Plans	✓		1965 & 1981	
Inclosure				
Tithe				
1910 Finance Act				
Rights of Way Act 1932				
Railway/Canal Plans				
Other Evidence				Locked Gates
User Evidence				
Photographs	✓			Taken as part of CYC surveys

Utility Companies Affected	Yes	No	Date (if applicable)	Other Information
British Gas		✓		
BT		✓		
Cable & Wireless				
Northern Electric	✓			
NTL Network Services		✓		
Torch Telecom		✓		
Yorkshire Water	✓			
York Waterworks		✓		

**Recommendation:**

No further Action at this time



9 St. Leonards Place, York, YO1 2ET  
Telephone: 01904 613161

### York, Footpath No 115 (Westfield Ward)

Scale 1:500	Drawn By:	Date:
Public Rights of Way	Reference:	Drawing No.

Reproduced from the Ordnance Survey with the permission of the Controller of Her Majesty's Stationery Office © Crown copyright.  
Unauthorized reproduction infringes Crown copyright and may lead to prosecution or civil proceedings. City of York Council 100020R18

**Public Rights Of Way – Wildlife & Countryside Act 1981  
Preparation of Definitive Map Former County Borough of York – Westfield**

Schedule 51

**Ward:** Westfield  
**Status:** Public Footpath  
**Path No:** 116 (Westfield)

**Description of route**

Footpath starting between 65 & 67 Kingsway West and running north-east alongside Holgate Beck to Green Lane then running south easterly along the southern bank of Holgate Beck, then southerly down a grass track onto Hob Moor to terminate at its junction with York 38, 44-46.

**Approximate length**

535 Metres

**Nature of Surface:**

<u>Start Grid Reference</u>	<u>End Grid Reference</u>	<u>Surface Type</u>
SE 5773 5068	SE 5815 5060	Tarmac
SE 5815 5060	SE 5813 5058	Grass

**Approximate Width:**

<u>Start Grid Reference</u>	<u>End Grid Reference</u>	<u>Width</u>
SE 5773 5068	SE 5777 5068	1.2m
SE 5777 5068	SE 5813 5058	2m

**Structures: (Stiles, Gates and Bridges etc)**

<u>Structure</u>	<u>Grid Reference</u>	<u>Structure Reference</u>
Kissing Gate	SE 5786 5073	Y116a
Vehicle gate	SE 5815 5060	Y116c
Kissing gate	SE 5786 5073	Y116d

**Evidence Summary etc**

Documentary Evidence etc	Yes	No	Date (if applicable)	Other Information
OS Plans	✓		1965 & 1981	
Inclosure				
Tithe				
1910 Finance Act				
Rights of Way Act 1932				
Railway/Canal Plans				
Other Maps				
User Evidence				
Photographs	✓			Taken as part of CYC surveys

Utility Companies Affected	Yes	No	Date (if applicable)	Other Information
British Gas		✓		
BT		✓		
Cable & Wireless				
Northern Electric	✓			
NTL Network Services		✓		
Torch Telecom		✓		
Yorkshire Water		✓		
York Waterworks		✓		

**Recommendation:**

Make Order to add route to Definitive Map and Statement

457800

457900

458000

458100

450900  
450800  
450700  
450600  
450500  
450400

450900  
450800  
450700  
450600  
450500  
450400

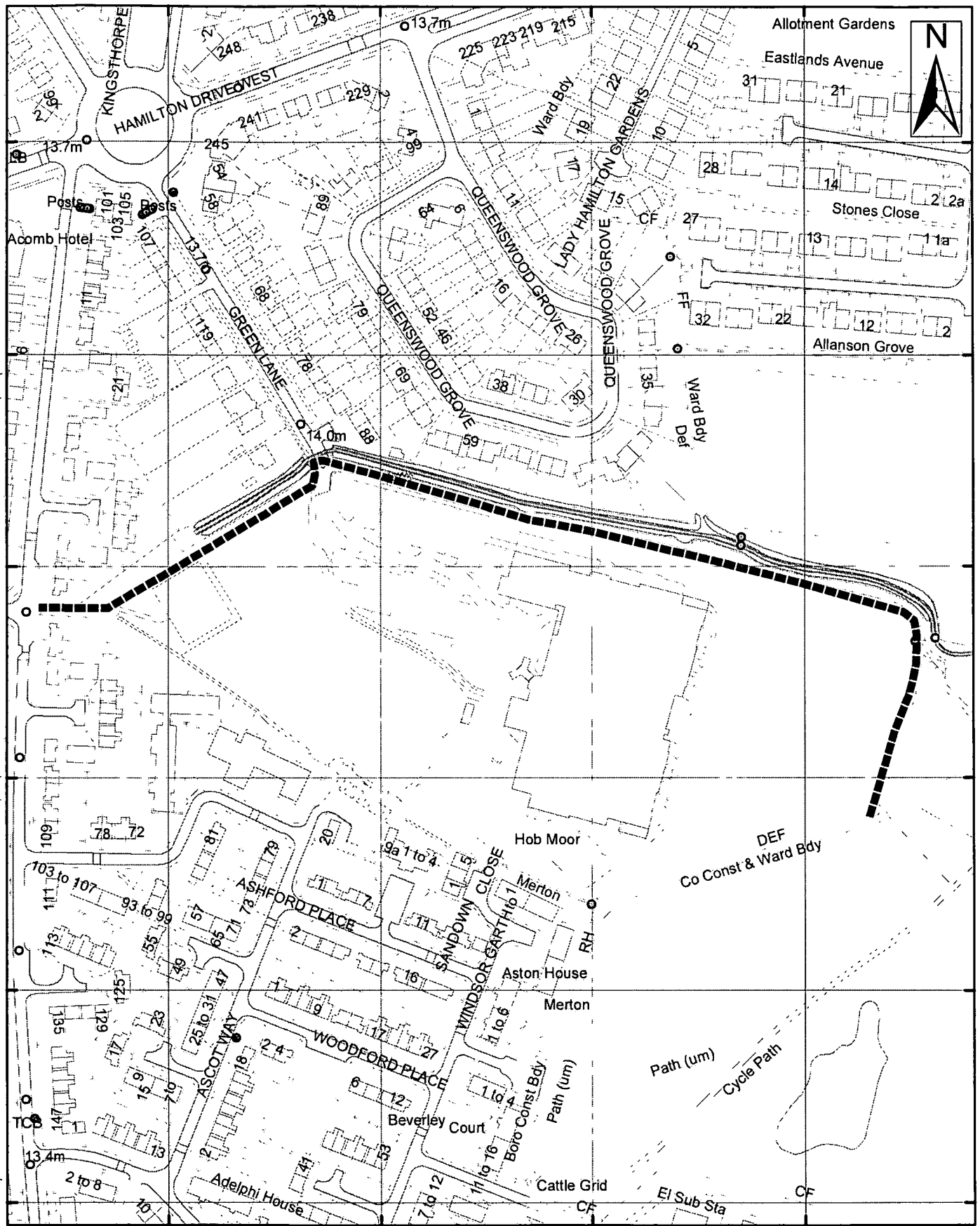

457800

457900

458000

458100



9 St. Leonards Place, York, YO1 2ET  
Telephone: 01904 613161

## York, Footpath No 116 (Westfield; Dringhouses and Woodthorpe Wards)

Scale 1:2,500

Drawn By:

Date:

Public Rights of Way

Reference:

Drawing No.

Reproduced from the Ordnance Survey with the permission of the Controller of Her Majesty's Stationery Office © Crown copyright.  
Unauthorized reproduction infringes Crown copyright and may lead to prosecution or civil proceedings. City of York Council 100020R1R